

Single Acting Rams, ESR-Series

ESR

Series

■ 24 Standard Model

■ Spring-Return

■ Steel Cover Nut

■ Optional Collar Threads Available

Capacity
10 ~ 100 tons

Stroke
50 ~ 200 mm

Max Operating Pressure
700 kg/cmf

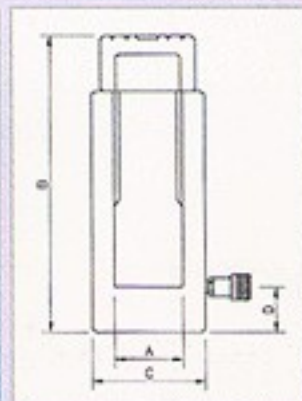

▼ ORDER SELECTION CHART

MODEL	Cylinder Capacity (tons)	Stroke (mm)	Effective Area (cmf)	A	B	C	D	Coupler Port	Max. Pressure (kg/cmf)	Weight (kg)
				Bore Diameter (mm)	Collapsed Diameter (mm)	Cylinder Diameter (mm)	Coupler Port Length (mm)			
ESR-550	5	50	7.07	30	144	50	24	3/8"PT	700	1.5
ESR-5100		100			194					1.9
ESR-5150		150			244					2.5
ESR-5200		200			294					3
ESR-1050	10	50	15.9	45	147	62	30			3.2
ESR-10100		100			167					3.8
ESR-10150		150			247					4.5
ESR-10200		200			267					5.2
ESR-2050	20	50	33.17	65	160	86	35			5.6
ESR-20100		100			210					7.8
ESR-20150		150			260					9.9
ESR-20200		200			310					12
ESR-3050	30	50	44.16	75	172	102	35			8
ESR-30100		100			222					11.8
ESR-30150		150			272					15.6
ESR-30200		200			322					19.4
ESR-5050	50	50	70.85	95	189	130	35			19
ESR-50100		100			239					22.7
ESR-50150		150			289					26.4
ESR-50200		200			339					30
ESR-10050	100	50	143.07	135	222	170	45			22
ESR-100100		100			272					45
ESR-100150		150			322	57				
ESR-100200		200			372	69				

Short Rams, ESSR / EHSR-Series

ESSR.EHSR

Series

- 12 Standard Model
- Load-Return
- Low Height

Capacity
10 ~ 100 tons

Stroke
50 ~ 20 mm

Max Operating Pressure
700 kg/cmf

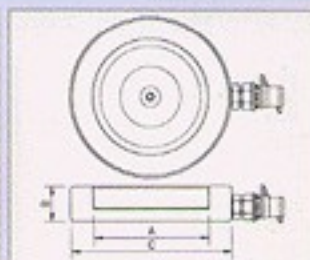

▼ ORDER SELECTION CHART

MODEL	Capacity (tons)	Stroke (mm)	Effective Area (cmf)	A B C			Oil Capacity (cc)	Max Pressure (kg/cmf)	Weight (kg)	Coupler Port
				Bore Diameter (mm)	Collapsed Height (mm)	Cylinder Diameter (mm)				
ESSR-3010	30	10	44.2	75	47	98	44	700	3	3/8PT
ESSR-1009	100	9	143.1	135	35	195	129		8.2	
ESSR-10012	100	12	143.1	135	40	195	172		9.4	
ESSR-1506	150	6	213.7	165	33	216	128		9.2	
ESSR-15013	150	13	213.7	165	40	216	278		11.2	
ESSR-15018	150	18	213.7	165	50	216	385		14.1	
EHSR-1009	100	9	50.3	80	35	125	45	2000	3.4	1/4PF
EHSR-10012	100	12	50.3	80	40	125	60		3.9	
EHSR-10016	100	16	50.3	80	57	125	80		5.5	
EHSR-15016	150	16	100	100	68	150	126		9.5	
EHSR-20016	200	16	113	120	67	175	180.8		12	
EHSR-20020	200	20	113	120	71	175	226		13.5	

Compact Profil Rams ECPR-Series

ECPR

Series

- 18 Standard Model
- Spring-Return
- Steel Cover Nut
- Low Height

Capacity
10 ~ 200 Tons

Stroke
38 ~ 50 mm

Max Operating Pressure
700 Kg/cmf

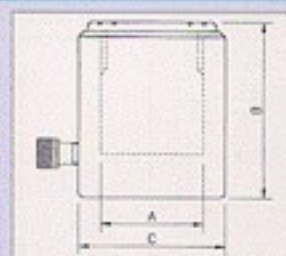

▼ ORDER SELECTION CHART

MODEL	Capacity (tons)	Stroke (mm)	Effective Area (cmf)	A B C			Oil Capacity (mm)	Max Pressure (kg/cmf)	Weight (kg)	Coupler Port
				Bore Diameter (mm)	Collapsed Height (mm)	Cylinder Diameter (mm)				
ECPR-1040	10	40	15.9	45	118	63	64	700	2.6	3/8PT
ECPR-1044	10	44	15.9	45	99	68	66		3.2	
ECPR-1050	10	50	15.9	45	128	63	80		2.7	
ECPR-1540	15	40	22.9	54	118	74	92		3.3	
ECPR-1550	15	50	22.9	54	128	74	115		3.7	
ECPR-2038	20	38	31.2	63	98	85	119		4	
ECPR-2040	20	40	31.2	63	118	85	125		4.5	
ECPR-2050	20	50	31.2	63	128	85	156		4.9	
ECPR-2540	25	40	36.3	68	130	90	145		5.5	
ECPR-2550	25	50	36.3	68	140	90	182		5.7	
ECPR-3040	30	40	44.2	75	130	97	177		6.5	
ECPR-3044	30	44	44.2	75	99	105	195		6.8	
ECPR-3050	30	50	44.2	75	140	97	221		6.8	
ECPR-5050	50	50	70.8	95	150	122	354		11.5	
ECPR-10050	100	50	132.7	135	139	175	664		20.4	
ECPR-15035	150	35	165	165	150	216	748		39	
ECPR-15050	150	50	213.7	165	165	216	1069		42	
ECPR-20035	200	35	283.4	190	155	245	992		53	

Aluminium Rams, ESRA-Series

ESRA

Series

- 14 Standard Model
- Spring-Return
- Steel Cover Nut
- Low Weight

Capacity
20 ~ 200 tons

Stroke
50 ~ 150 mm

Max Operating Pressure
700 kg/cm²

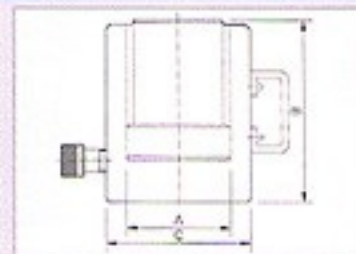

▼ ORDER SELECTION CHART

MODEL	Capacity (tons)	Stroke (mm)	Effective Area (cm ²)	A B C			Oil Capacity (cc)	Max. Pressure (kg/cm ²)	Weight (kg)
				Bore Diameter (mm)	Collapsed Diameter (mm)	Cylinder Diameter (mm)			
ESRA-2050	20	50	29	60	140	89	145	700	3
ESRA-20100	20	100			193		290		4
ESRA-20150	20	150			243		435		5
ESRA-3050	30	50	42	73	163	118	220		5
ESRA-30100	30	100			213		440		6.5
ESRA-30150	30	150			263		660		8
ESRA-5050	50	50	71	95	173	138	355		6
ESRA-50100	50	100			223		780		10.5
ESRA-50150	50	150			273		1070		15
ESRA-10050	100	50	132	130	185	188	660		16
ESRA-100100	100	100			235		1320		19.5
ESRA-100150	100	150			285		1980		23
ESRA-15050	150	50	214	165	205	250	1070		27
ESRA-20050	200	50	284	190	220	280	1420		34

Lock Nut Rams, ELNR-Series

ENLR

Series

- 5 Standard Model
- Load-Return
- Steel Cover Nut

Capacity
30 ~ 200 tons

Stroke
200 ~ 230 mm

Max Operating Pressure
700 Kg/cm²



▼ ORDER SELECTION CHART

MODEL	Capacity (tons)	Stroke (mm)	Effective Area (cm ²)	A B C			Oil Capacity (cc)	Max. Pressure (kg/cm ²)	Weight (kg)
				Bore Diameter (mm)	Collapsed Height (mm)	Cylinder Diameter (mm)			
ELNR-30200	30	200	38.4	70	405	102	883	700	23
ELNR-50200	50	200	63.6	90	424	127	1141		38
ELNR-100230	100	230	132.7	130	499	185	3292		95
ELNR-150230	150	230	201	160	578	225	4918		164
ELNR-200230	200	230	268.8	185	615	255	6562		224

Aluminium Rams, ESRA-Series

ESRA

Series

- 14 Standard Model
- Spring-Return
- Steel Cover Nut
- Low Weight

Capacity
20 ~ 200 tons

Stroke
50 ~ 150 mm

Max Operating Pressure
700 kg/cm²

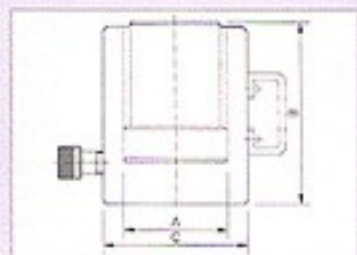

▼ ORDER SELECTION CHART

MODEL	Capacity (tons)	Stroke (mm)	Effective Area (cm ²)	A	B	C	Oil Capacity (cc)	Max. Pressure (kg/cm ²)	Weight (kg)
				Bore Diameter (mm)	Collapsed Diameter (mm)	Cylinder Diameter (mm)			
ESRA-2050	20	50	29	60	140	89	145	700	3
ESRA-20100	20	100			193		290		4
ESRA-20150	20	150			243		435		5
ESRA-3050	30	50	42	73	163	118	220		5
ESRA-30100	30	100			213		440		6.5
ESRA-30150	30	150			263		660		8
ESRA-5050	50	50	71	95	173	138	355		6
ESRA-50100	50	100			223		780		10.5
ESRA-50150	50	150			273		1070		15
ESRA-10050	100	50	132	130	185	188	660		16
ESRA-100100	100	100			235		1320		19.5
ESRA-100150	100	150			285		1980		23
ESRA-15050	150	50	214	165	205	250	1070		27
ESRA-20050	200	50	284	190	220	280	1420		34

Lock Nut Rams, ELNR-Series

ENLR

Series

- 5 Standard Model
- Load-Return
- Steel Cover Nut

Capacity
30 ~ 200 tons

Stroke
200 ~ 230 mm

Max Operating Pressure
700 Kg/cm²

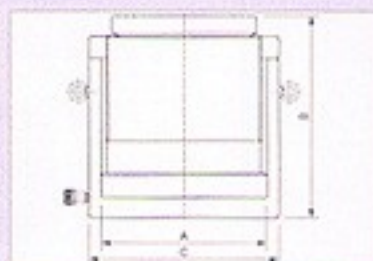

▼ ORDER SELECTION CHART

MODEL	Capacity (tons)	Stroke (mm)	Effective Area (cm ²)	A	B	C	Oil Capacity (cc)	Max. Pressure (kg/cm ²)	Weight (kg)
				Bore Diameter (mm)	Collapsed Height (mm)	Cylinder Diameter (mm)			
ELNR-30200	30	200	38.4	70	405	102	883	700	23
ELNR-50200	50	200	63.6	90	424	127	1141		38
ELNR-100230	100	230	132.7	130	499	185	3292		95
ELNR-150230	150	230	201	160	578	225	4918		164
ELNR-200230	200	230	268.8	185	615	255	6562		224

Double Acting Rams, EDR-Series

EDR

Series

- 27 Standard Model
- Hydraulic-Return
- Steel Cover Nut
- Optional Collar Threads Available

Capacity
10 ~ 1,000 tons

Stroke
50 ~ 500 mm

Max Operating Pressure
700 kg/cm²

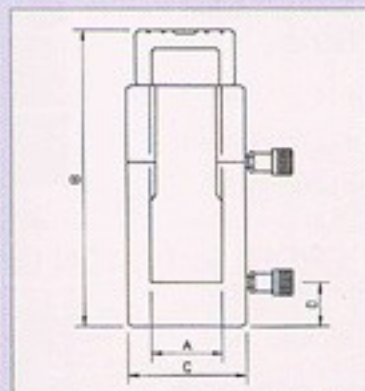

▼ ORDER SELECTION CHART

MODEL	Cylinder Capacity (tons)	Stroke (mm)	Oil Capacity (mm)	Effective Area (cm ²)	A	B	C	D	Coupler Port	Max. Pressure (kg/cm ²)	Weight (kg)
					Bore Diameter (mm)	Collapsed Height (mm)	Cylinder Diameter (mm)	Coupler Port Length (mm)			
EDR-10100	10	100	152	15.6	45	264	62	35	3/8"PT	700	4.5
EDR-10250		250	380			414					8
EDR-20150	20	150	497	33.17	65	362	40	13.5			
EDR-20300		300	995			512		20			
EDR-20500	500	1659	712	24							
EDR-30150	30	150	663	44.16	75	396	45	24			
EDR-30300		300	825			546		33			
EDR-30500	500	1041	746	45							
EDR-50150	50	150	1063	70.85	95	422	50	30			
EDR-50300		300	2126			572		50			
EDR-50500	500	3554	772	62							
EDR-100150	100	150	2147	143.07	135	474	60	64			
EDR-100300		300	4294			624		83			
EDR-100500	500	7157	824	140							
EDR-200150	200	150	4285	283.53	190	515	70	135			
EDR-200300		300	8505			665		190			
EDR-200500	500	14176	865	250							
EDR-300150	300	150	6506	433.74	235	570	80	150			
EDR-300300		300	13012			720		298			
EDR-300500	500	21607	920	450							
EDR-500150	500	150	10603	706.85	300	620	90	440			
EDR-500300		300	21205			770		530			
EDR-500500	500	35342	970	800							
EDR-800150	800	150	17462	1164.2	385	550	90	782			
EDR-800300		300	34924			700		989			
EDR-1000150	1000	150	21783	1452.2	430	610	90	1216			
EDR-1000300		300	43566			760		1533			

Low Profile Rams, ELPR-Series

ELPR

Series

- 7 Standard Model
- Spring-Return
- Steel Cover Nut
- Low Height

Capacity
10 ~ 150 tons

Stroke
5 ~ 20 mm

Max Operating Pressure
700 kg/cm²

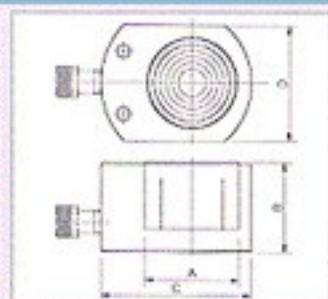

▼ ORDER SELECTION CHART

MODEL	Capacity (tons)	Stroke (mm)	Effective Area (cm ²)	A	B	C	D	Oil Capacity (cc)	Weight (kg)
				Bore Diameter (mm)	Collapsed Height (mm)	Cylinder Diameter (mm)	Width Size (mm)		
ELPR-1010	10	10	15.2	44	53	82	55	15.2	1.6
ELPR-2012	20	12	31.2	63	52	100	76	37.4	2.9
ELPR-3013	30	13	44.2	75	59	115	94	57.5	3.9
ELPR-5015	50	15	70.8	95	65	145	120	106.2	6.5
ELPR-7515	75	15	102.1	114	79	165	135	153.2	11
ELPR-10015	100	15	143.1	135	85	177	152	214.7	14
ELPR-15015	150	15	213.7	165	100	216	188	320.6	25

Center Hole Rams, ESCH / EDCH - Series

ESCH, EDCH

Series

- 9 Standard Model
- Spring-Return
- Hydraulic-Return
- Steel Cover Nut

Capacity
10 ~ 100 Tons

Stroke
40 ~ 300 mm

Max Operating Pressure
700 kg/cm²

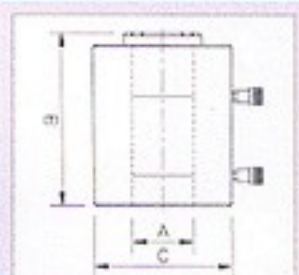

▼ ORDER SELECTION CHART

MODEL	Capacity (tons)	Stroke (mm)	Effective Area (cm ²)	A	B	C	Oil Capacity (cc)	Weight (kg)
				Center Hole Diameter (mm)	Collapsed Height (mm)	Cylinder Diameter (mm)		
ESCH-1040	10	40	17.2	20	121	70	70.5	2.8
ESCH-2050	20	50	31.7	27	135	98	158.4	5
ESCH-3060	30	60	47.7	36	178	115	300.6	11.5
ESCH-5075	50	75	85.5	54	235	159	650	28.1
ESCH-10075	100	75	138.1	80	254	216	1049	52.5
EDCH-10254	10	254	14.4	20	406	70	365	11
EDCH-30210	30	210	44.2	33	425	115	928	24
EDCH-50156	50	156	70.9	54	380	159	1106	38
EDCH-100168	100	168	132.7	80	382	216	2230	51

Short Rams, ESSR / EHSR - Series

ESSR.EHSR

Series

- 12 Standard Model
- Load-Return
- Low Height

Capacity
10 ~ 100 tons

Stroke
50 ~ 20 mm

Max Operating Pressure
700 kg/cmf

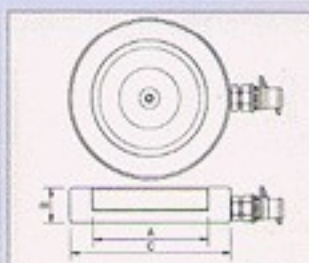

▼ ORDER SELECTION CHART

MODEL	Capacity (tons)	Stroke (mm)	Effective Area (cmf)	A B C			Oil Capacity (cc)	Max Pressure (kg/cmf)	Weight (kg)	Coupler Port
				Bore Diameter (mm)	Collapsed Height (mm)	Cylinder Diameter (mm)				
ESSR-3010	30	10	44.2	75	47	98	44	700	3	3/8PT
ESSR-1009	100	9	143.1	135	35	195	129		8.2	
ESSR-10012	100	12	143.1	135	40	195	172		9.4	
ESSR-1506	150	6	213.7	165	33	216	128		9.2	
ESSR-15013	150	13	213.7	165	40	216	278		11.2	
ESSR-15018	150	18	213.7	165	50	216	385		14.1	
EHSR-1009	100	9	50.3	80	35	125	45	2000	3.4	1/4PF
EHSR-10012	100	12	50.3	80	40	125	60		3.9	
EHSR-10016	100	16	50.3	80	57	125	80		5.5	
EHSR-15016	150	16	100	100	68	150	126		9.5	
EHSR-20016	200	16	113	120	67	175	180.8		12	
EHSR-20020	200	20	113	120	71	175	226		13.5	

Compact Profil Rams ECPR - Series

ECPR

Series

- 18 Standard Model
- Spring-Return
- Steel Cover Nut
- Low Height

Capacity
10 ~ 200 Tons

Stroke
38 ~ 50 mm

Max Operating Pressure
700 Kg/cmf

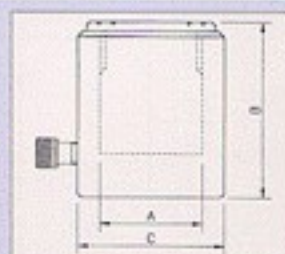

▼ ORDER SELECTION CHART

MODEL	Capacity (tons)	Stroke (mm)	Effective Area (cmf)	A B C			Oil Capacity (mm)	Max Pressure (kg/cmf)	Weight (kg)	Coupler Port
				Bore Diameter (mm)	Collapsed Height (mm)	Cylinder Diameter (mm)				
ECPR-1040	10	40	15.9	45	118	63	64	700	2.6	3/8PT
ECPR-1044	10	44	15.9	45	99	68	66		3.2	
ECPR-1050	10	50	15.9	45	128	63	80		2.7	
ECPR-1540	15	40	22.9	54	118	74	92		3.3	
ECPR-1550	15	50	22.9	54	128	74	115		3.7	
ECPR-2038	20	38	31.2	63	98	85	119		4	
ECPR-2040	20	40	31.2	63	118	85	125		4.5	
ECPR-2050	20	50	31.2	63	128	85	156		4.9	
ECPR-2540	25	40	36.3	68	130	90	145		5.5	
ECPR-2550	25	50	36.3	68	140	90	182		5.7	
ECPR-3040	30	40	44.2	75	130	97	177		6.5	
ECPR-3044	30	44	44.2	75	99	105	195		6.8	
ECPR-3050	30	50	44.2	75	140	97	221		6.8	
ECPR-5050	50	50	70.8	95	150	122	354		11.5	
ECPR-10050	100	50	132.7	135	139	175	664		20.4	
ECPR-15035	150	35	165	165	150	216	748		39	
ECPR-15050	150	50	213.7	165	165	216	1069		42	
ECPR-20035	200	35	283.4	190	155	245	992		53	