

# 166 Abrasive Bands and Mandrels

Page	
<b>148</b>	Qualities and Applications
<b>167</b>	Abrasive Bands, cylindrical
<b>169</b>	Mandrels for cylindrical shape
<b>171</b>	Abrasive Bands, conical
<b>171</b>	Mandrels for conical shape

Page	
<b>172</b>	Grinding rolls
<b>172</b>	Mounting device for grinding rolls
<b>172</b>	Linishing belts
<b>225</b>	

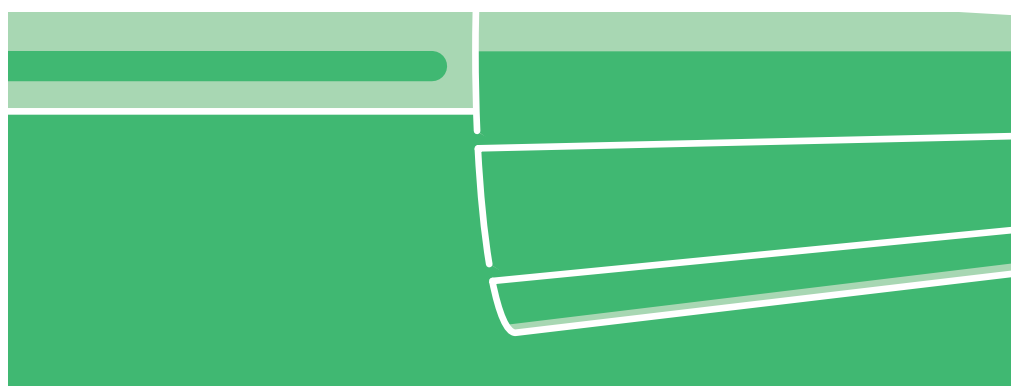

## SBZY, Abrasive Bands, cylindrical shape

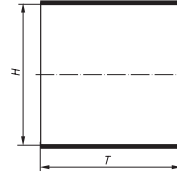

Description	H mm	T mm	available grits NK							
			40	50	60	80	120	150	240	320
SBZY 00810	8	10	--	--	--	○	○	■	○	○
SBZY 01010	10	10	--	--	○	■	○	■	■	■
SBZY 01020	10	20	--	--	○	■	○	■	■	■
SBZY 01210	12	10	--	--	○	■	○	■	■	○
SBZY 01213	12	13	--	--	○	■	■	○	■	○
SBZY 01225	12	25	--	--	○	■	○	■	■	■
SBZY 01250	12	50	--	--	○	■	○	○	○	○
SBZY 01310	13	10	--	--	○	■	○	■	○	○
SBZY 01325	13	25	--	--	○	■	○	■	○	○
SBZY 01510	15	10	--	--	■	■	○	■	■	■
SBZY 01530	15	30	■	■	■	■	■	■	■	■
SBZY 01550	15	50	○	■	○	○	○	○	○	○
SBZY 01925	19	25	○	■	■	■	○	■	○	○
SBZY 02210	22	10	○	○	○	○	○	■	■	■
SBZY 02220	22	20	○	■	■	■	○	■	■	■
SBZY 02250	22	50	○	■	○	○	○	○	○	○
SBZY 02525	25	25	■	■	■	■	○	■	○	○
SBZY 03020	30	20	■	■	■	■	○	■	■	○
SBZY 03030	30	30	■	■	■	■	○	■	■	■
SBZY 03825	38	25	■	■	■	■	○	■	○	○
SBZY 04530	45	30	■	■	■	■	○	■	■	■
SBZY 05125	51	25	■	■	■	■	○	■	○	○
SBZY 06030	60	30	■	■	■	■	○	■	○	○
SBZY 07530	75	30	■	■	■	■	○	■	○	○
SBZY 10040	100	40	■	■	■	■	○	■	○	○

Packing unit: 50 pcs. per type

Ordering example: SBZY 01225 NK 80

## SBZY, Abrasive Bands, cylindrical shape zirconia alum. oxide

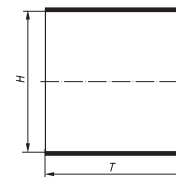

Description	H mm	T mm	available grits ZK			
			36	50	60	80
SBZY 01325 ZK	13	25	--	■	○	■
SBZY 01530 ZK	15	30	--	■	■	■
SBZY 01925 ZK	19	25	■	■	○	■
SBZY 02220 ZK	22	20	■	■	■	○
SBZY 02525 ZK	25	25	■	■	○	■
SBZY 03030 ZK	30	30	■	■	■	■
SBZY 03825 ZK	38	25	■	■	○	■
SBZY 04530 ZK	45	30	■	■	■	■
SBZY 05125 ZK	51	25	■	■	○	■
SBZY 06030 ZK	60	30	■	■	■	■

Packing unit: 50 pcs. per type

Ordering example: SBZY 01325 ZK 50

n<sub>max.</sub>: please refer to band mandrels on page 169.

## SBZY, Abrasive Bands, cylindrical shape, zirconia alum. oxide POWER

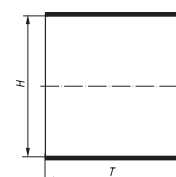

Description	H mm	T mm	available grits Z POWER			
			36	50	60	80
SBZY 03030 Z POWER	30	30	■	■	■	■
SBZY 04530 Z POWER	45	30	■	■	■	■
SBZY 06030 Z POWER	60	30	■	■	■	■

Packing unit: 50 pcs. per type

Ordering example: SBZY 03030 Z POWER 50

n<sub>max.</sub>: please refer to band mandrels on page 169.

■ delivery ex-stock

▲ quick delivery

○ available as special service

Ⓢ regrind service, please enquire



## STZY, Mandrels cylindrical shape

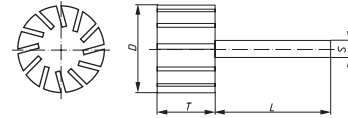

Description	D mm	T mm	S mm	L mm	Quality/Operating speed		H = Hard	W = Soft
					n <sub>max. Hard</sub> (1/min)	n <sub>max. Soft</sub> (1/min)		
STZY 00810.03	8	10	3	40	57000	47500	○	■
STZY 01010.03	10	10	3	25	54000	38000	■	○
STZY 01010.06	10	10	6	40	57000	38000	■	○
STZY 01020.06	10	20	6	40	57000	38000	■	○
STZY 01210.06	12	10	6	40	46500	31500	■	○
STZY 01213.02	12	13	2,35	40	26000	26000	■	○
STZY 01225.06	12	25	6	40	46500	31500	■	■
STZY 01250.06	12	50	6	40	31500	31500	■	○
STZY 01310.06	13	10	6	40	44000	29000	■	○
STZY 01325.06	13	25	6	40	44000	29000	■	○
STZY 01510.06	15	10	6	40	38000	25000	■	○
STZY 01530.06	15	30	6	40	38000	25000	■	■
STZY 01550.06	15	50	6	40	25000	25000	■	○
STZY 01925.06	19	25	6	40	30000	20000	■	○

Packing unit: 5 pcs. per type, from Ø 75 mm = 2 pcs. per type

Ordering example: STZY 01210.06 H

The stated maximum operating speed only applies to a maximum overhang  $L_0$  of 20 mm. Other overhang dimensions must be calculated separately.

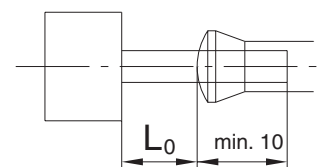

## STZY, Mandrels cylindrical shape

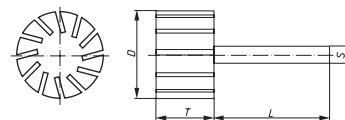

Description	D mm	T mm	S mm	L mm	Quality/Operating speed		H = Hard	W = Soft
					n <sub>max.</sub> Hard (1/min)	n <sub>max.</sub> Soft (1/min)		
STZY 02210.06	22	10	6	40	26000	17000	■	○
STZY 02220.06	22	20	6	40	26000	17000	■	■
STZY 02250.06	22	50	6	40	17000	17000	■	○
STZY 02525.06	25	25	6	40	22500	15000	■	○
STZY 03020.06	30	20	6	40	19000	12500	■	■
STZY 03030.06	30	30	6	40	19000	12500	■	■
STZY 03825.06	38	25	6	40	15000	10000	■	○
STZY 04530.06	45	30	6	40	13000	13000	■	■
STZY 05125.06	51	25	6	40	11200	8000	■	○
STZY 06030.06	60	30	6	40	9500	6500	■	■
STZY 06030.08	60	30	8	40	9500	6500	■	○
STZY 07530.08	75	30	8	40	6500	5000	■	○
STZY 10040.08	100	40	8	40	5800	4000	○	■

Packing unit: 5 pcs. per type, from Ø 75 mm = 2 pcs. per type

Ordering example: STZY 04530.06 H

The stated maximum operating speed only applies to a maximum overhang  $L_0$  of 20 mm. Other overhang dimensions must be calculated separately.

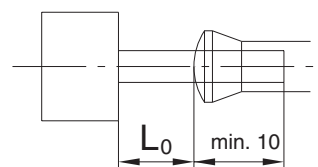

## SBKE, Abrasive Bands, conical shape

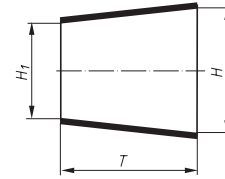

Description	H mm	T mm	H <sub>1</sub> mm	available grits, Reg. al.-oxide NK							
				40	50	60	80	120	150	240	320
SBKE 02063	20	63	14	■	○	■	■	○	■	○	○
SBKE 02930	29	30	22	■	■	■	■	○	■	○	○
SBKE 03660	36	60	22	■	■	■	■	○	■	○	○

Packing unit: 50 pcs. per type

Ordering example: SBKE 02063 NK 80

n<sub>max.</sub>: please refer to band mandrels below.

## STKE, Mandrels for conical shape

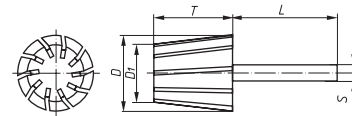

Description	D mm	T mm	S mm	D <sub>1</sub> mm	L mm	n <sub>max.</sub> (1/min)	available hardness H = hard
STKE 02063.06	20	63	6	14	40	21000	■
STKE 02930.06	29	30	6	22	40	21000	■
STKE 03660.06	36	60	6	22	40	13500	■

Packing unit: 5 pcs. per type

Ordering example: STKE 02063.06 H

The stated maximum operating speed only applies to a maximum overhang  $L_0$  of 20 mm. Other overhang dimensions must be calculated separately.

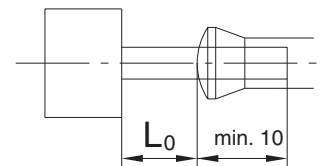

## SBZY, Grinding rolls

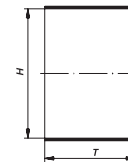

Description	H mm	T mm	available grits, Reg. al.-oxide NK							
			40	50	60	80	120	150	240	320
SBZY 100100	100	100	--	--	■	■	■	■	--	--

Packing unit: 6 pcs. per type

Ordering example: SBZY 100100 NK80

## STWS, Mounting device for grinding rolls

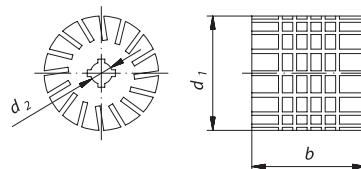

Description	d <sub>1</sub> mm	b mm	Bore d <sub>2</sub> mm	n <sub>max.</sub> (1/min.)	
STWS 100100	100	100	19	2800	■

Packing unit: 1 pc. per type

Ordering example: STWS 100100

The bore Ø 19 mm has a keyway of 6 mm.

Machines to suit: Page 235.

## SBL, finishing belts



Description	B mm	Length mm	Lining	available grits NK		
				60	80	120
SBLT	13	305	robust - flexible	■	■	■
SBLX	13	305	robust	■	■	■

Packing unit: 100 pcs. per type

Ordering example: SBLT 13305 NK 60

used on our pneumatic belt grinder AMIN 30 BSH, page 228

Belt speed: 28 m/s