

Mounted flap wheels of abrasive cloth

222 Qualities and Applications

252 General Information

253 Mounted flap wheels of abrasive cloth, recessed

253 Mounted flap wheels of abrasive cloth

260 Mounted flap wheels of abrasive cloth, slotted

261 Mounted flap wheels of abrasive cloth, SFE

262 Mounted flap wheels of abrasive cloth, SFC

263 Mounted flap wheels with internal thread

264 Mounted flap wheels with threaded shank

265 Mini-Flap wheels of abrasive cloth

373 Air tools

Product line marking

Product lines are labelled in the table header with the appropriate tabs. Further information on page **14** and **15**.

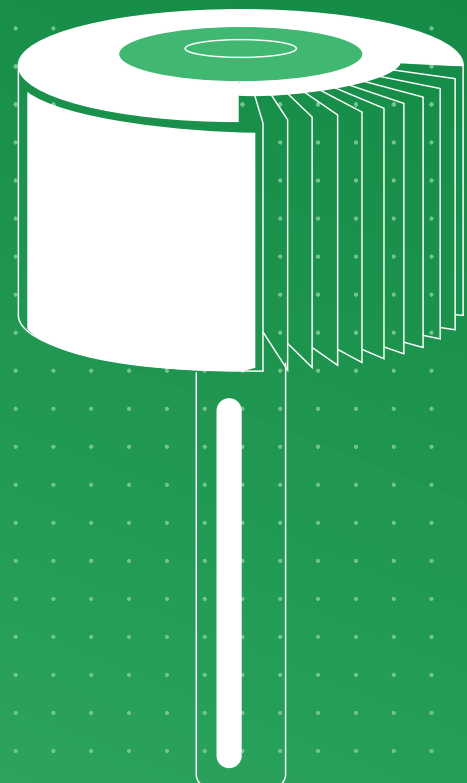

Information

SFL, mounted flap wheels of abrasive cloth

These tools consist of individual flaps radially located around the hub of the tool; they are mainly used in hand-held power tools.

We offer our coated abrasive flap wheels in various qualities i.e. NK, NKE and SIC.

Examples of application:

- finishing
- derusting
- fettling
- deburring
- surface grinding
- decorative finishing
- bevelling

SFB, Mounted flap wheels of abrasive cloth, slotted

By slotting the lamellas on the periphery, the flexibility of this type of mounted flap wheel is increased. The slotted flap wheel quickly profiles itself to the contour of the workpiece.

SFT, Mounted flap wheels of abrasive cloth, recessed

These tools are suitable for face and peripheral grinding.

Adaptor for SFI and SFA

These adaptors extend the shank length and optimise down-time. Tool change is made without removing the adaptor from the machine.



High Performance

SFT, Flap wheels – recessed

Ordering example: A3100040306060

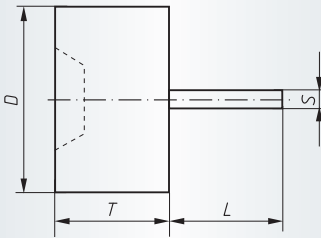
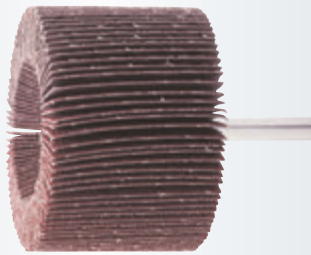

Packing unit:

10 pcs. per type

Further dimensions, qualities

and shank lengths on request

NK = reg. Aluminium Oxide

Description	Grits	D mm	T mm	S mm	L mm	n recom. (1/min)	n max. (1/min)	Product-Number	recommended for	
SFT 04030.06	NK 60	40	30	6	40	12.000	18.000	A3100040306060	① ② ③ ④ ⑤ ⑥ ⑦ ⑧	■
SFT 04030.06	NK 80	40	30	6	40	12.000	18.000	A3100040306080	① ② ③ ④ ⑤ ⑥ ⑦ ⑧	■
SFT 04030.06	NK 150	40	30	6	40	12.000	18.000	A3100040306150	① ② ③ ④ ⑤ ⑥ ⑦ ⑧	■
SFT 06040.06	NK 60	60	40	6	40	8.000	8.500	A3100060406060	① ② ③ ④ ⑤ ⑥ ⑦ ⑧	■
SFT 06040.06	NK 80	60	40	6	40	8.000	8.500	A3100060406080	① ② ③ ④ ⑤ ⑥ ⑦ ⑧	■
SFT 06040.06	NK 150	60	40	6	40	8.000	8.500	A3100060406150	① ② ③ ④ ⑤ ⑥ ⑦ ⑧	■

The stated maximum operating speed only applies to a maximum overhang

L_0 of 20 mm. Other overhang dimensions must be calculated separately.

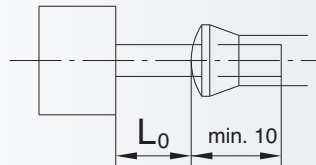

Industry

SFL, Flap wheels

Ordering example: A2200010103080

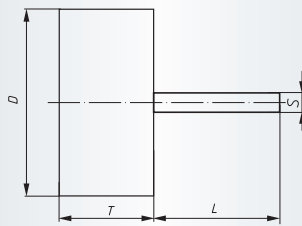
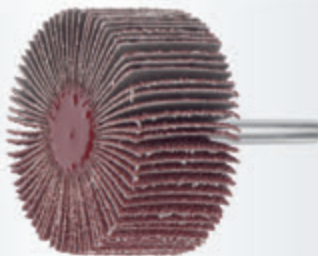

Packing unit:

10 pcs. per type

Further dimensions, qualities

and shank lengths on request

NK = reg. Aluminium Oxide

Description	Grits	D mm	T mm	S mm	L mm	n recom. (1/min)	n max. (1/min)	Product-Number	recommended for	
SFL 01010.03	NK 80	10	10	3	40	26.000	35.000	A2200010103080	① ② ③ ④ ⑤ ⑥ ⑦ ⑧	■
SFL 01010.03	NK 120	10	10	3	40	26.000	35.000	A2200010103120	① ② ③ ④ ⑤ ⑥ ⑦ ⑧	■
SFL 01010.03	NK 150	10	10	3	40	26.000	35.000	A2200010103150	① ② ③ ④ ⑤ ⑥ ⑦ ⑧	■
SFL 01010.03	NK 240	10	10	3	40	26.000	35.000	A2200010103240	① ② ③ ④ ⑤ ⑥ ⑦ ⑧	■
SFL 01015.03	NK 80	10	15	3	40	24.000	35.000	A2200010153080	① ② ③ ④ ⑤ ⑥ ⑦ ⑧	■
SFL 01510.03	NK 80	15	10	3	40	24.000	35.000	A2200015103080	① ② ③ ④ ⑤ ⑥ ⑦ ⑧	■
SFL 01510.03	NK 150	15	10	3	40	24.000	35.000	A2200015103150	① ② ③ ④ ⑤ ⑥ ⑦ ⑧	■
SFL 01515.03	NK 80	15	15	3	40	24.000	35.000	A2200015153080	① ② ③ ④ ⑤ ⑥ ⑦ ⑧	■
SFL 01515.03	NK 120	15	15	3	40	24.000	35.000	A2200015153120	① ② ③ ④ ⑤ ⑥ ⑦ ⑧	■
SFL 01515.03	NK 150	15	15	3	40	24.000	35.000	A2200015153150	① ② ③ ④ ⑤ ⑥ ⑦ ⑧	■
SFL 02005.06	NK 120	20	5	6	40	20.000	28.000	A2200020056120	① ② ③ ④ ⑤ ⑥ ⑦ ⑧	■
SFL 02010.03	NK 80	20	10	3	40	20.000	28.000	A2200020103080	① ② ③ ④ ⑤ ⑥ ⑦ ⑧	■

NEW

254 Mounted flap wheels of abrasive cloth



Industry

SFL, Flap wheels

Ordering example: A2200020103120

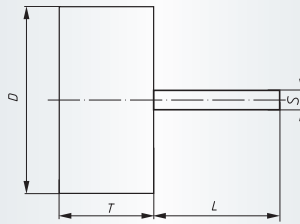
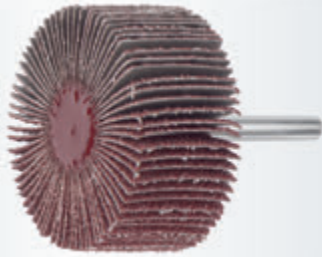

Packing unit:

10 pcs. per type

Further dimensions, qualities

and shank lengths on request

NK = reg. Aluminium Oxide

Description	Grits	D mm	T mm	S mm	L mm	n recom. (1/min)	n max. (1/min)	Product-Number	recommended for	
SFL 02010.03	NK 120	20	10	3	40	20.000	28.000	A2200020103120	1 2 3 4 5 6 7 8	■
SFL 02010.03	NK 150	20	10	3	40	20.000	28.000	A2200020103150	1 2 3 4 5 6 7 8	■
SFL 02010.03	NK 320	20	10	3	40	20.000	28.000	A2200020103320	1 2 3 4 5 6 7 8	■
SFL 02010.06	NK 80	20	10	6	40	20.000	28.000	A2200020106080	1 2 3 4 5 6 7 8	■
SFL 02010.06	NK 120	20	10	6	40	20.000	28.000	A2200020106120	1 2 3 4 5 6 7 8	■
SFL 02015.06	NK 60	20	15	6	40	20.000	28.000	A2200020156060	1 2 3 4 5 6 7 8	■
SFL 02015.06	NK 80	20	15	6	40	20.000	28.000	A2200020156080	1 2 3 4 5 6 7 8	■
SFL 02015.06	NK 120	20	15	6	40	20.000	28.000	A2200020156120	1 2 3 4 5 6 7 8	■
SFL 02015.06	NK 150	20	15	6	40	20.000	28.000	A2200020156150	1 2 3 4 5 6 7 8	■
SFL 02015.06	NK 240	20	15	6	40	20.000	28.000	A2200020156240	1 2 3 4 5 6 7 8	■
NEW SFL 02020.06	NK 80	20	20	6	40	20.000	28.000	A2200020206080	1 2 3 4 5 6 7 8	■
SFL 02505.03	NK 120	25	5	3	40	16.000	18.000	A2200025053120	1 2 3 4 5 6 7 8	■
SFL 02510.03	NK 80	25	10	3	40	16.000	18.000	A2200025103080	1 2 3 4 5 6 7 8	■
SFL 02510.03	NK 120	25	10	3	40	16.000	18.000	A2200025103120	1 2 3 4 5 6 7 8	■
SFL 02510.03	NK 150	25	10	3	40	16.000	18.000	A2200025103150	1 2 3 4 5 6 7 8	■
NEW SFL 02510.06	NK 80	25	10	6	40	16.000	18.000	A2200025106080	1 2 3 4 5 6 7 8	■
NEW SFL 02510.06	NK 120	25	10	6	40	16.000	18.000	A2200025106120	1 2 3 4 5 6 7 8	■
SFL 02515.06	NK 80	25	15	6	40	16.000	18.000	A2200025156080	1 2 3 4 5 6 7 8	■
SFL 02515.06	NK 120	25	15	6	40	16.000	18.000	A2200025156120	1 2 3 4 5 6 7 8	■
SFL 02515.06	NK 150	25	15	6	40	16.000	18.000	A2200025156150	1 2 3 4 5 6 7 8	■
NEW SFL 02520.06	NK 80	25	20	6	40	16.000	18.000	A2200025206080	1 2 3 4 5 6 7 8	■
NEW SFL 02520.06	NK 120	25	20	6	40	16.000	18.000	A2200025206120	1 2 3 4 5 6 7 8	■
SFL 02525.06	NK 80	25	25	6	40	16.000	18.000	A2200025256080	1 2 3 4 5 6 7 8	■
SFL 02525.06	NK 150	25	25	6	40	16.000	18.000	A2200025256150	1 2 3 4 5 6 7 8	■
SFL 03005.03	NK 60	30	5	3	40	16.000	18.000	A2200030053060	1 2 3 4 5 6 7 8	■
SFL 03005.03	NK 80	30	5	3	40	16.000	18.000	A2200030053080	1 2 3 4 5 6 7 8	■
SFL 03005.03	NK 120	30	5	3	40	16.000	18.000	A2200030053120	1 2 3 4 5 6 7 8	■
SFL 03005.03	NK 150	30	5	3	40	16.000	18.000	A2200030053150	1 2 3 4 5 6 7 8	■
SFL 03005.03	NK 240	30	5	3	40	16.000	18.000	A2200030053240	1 2 3 4 5 6 7 8	■
SFL 03005.03	NK 320	30	5	3	40	16.000	18.000	A2200030053320	1 2 3 4 5 6 7 8	■
SFL 03005.06	NK 60	30	5	6	40	16.000	18.000	A2200030056060	1 2 3 4 5 6 7 8	■
SFL 03005.06	NK 80	30	5	6	40	16.000	18.000	A2200030056080	1 2 3 4 5 6 7 8	■

The stated maximum operating speed only applies to a maximum overhang L_0 of 20 mm. Other overhang dimensions must be calculated separately.

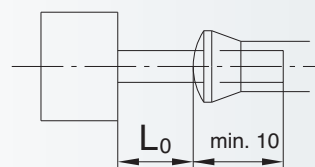



Industry

SFL, Flap wheels

Ordering example: A2200030056120

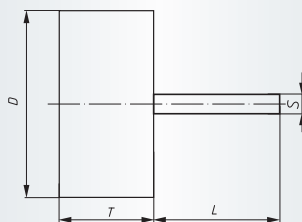
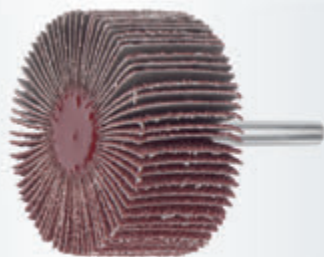

Packing unit:

10 pcs. per type

Further dimensions, qualities

and shank lengths on request

NK = reg. Aluminium Oxide

Description	Grits	D mm	T mm	S mm	L mm	n recom. (1/min)	n max. (1/min)	Product-Number	recommended for	
SFL 03005.06	NK 120	30	5	6	40	16.000	18.000	A2200030056120	① ② ③ ④ ⑤ ⑥ ⑦ ⑧	■
SFL 03005.06	NK 150	30	5	6	40	16.000	18.000	A2200030056150	① ② ③ ④ ⑤ ⑥ ⑦ ⑧	■
SFL 03005.06	NK 240	30	5	6	40	16.000	18.000	A2200030056240	① ② ③ ④ ⑤ ⑥ ⑦ ⑧	■
SFL 03005.06	NK 320	30	5	6	40	16.000	18.000	A2200030056320	① ② ③ ④ ⑤ ⑥ ⑦ ⑧	■
SFL 03010.03	NK 60	30	10	3	40	16.000	18.000	A2200030103060	① ② ③ ④ ⑤ ⑥ ⑦ ⑧	■
SFL 03010.03	NK 80	30	10	3	40	16.000	18.000	A2200030103080	① ② ③ ④ ⑤ ⑥ ⑦ ⑧	■
SFL 03010.03	NK 120	30	10	3	40	16.000	18.000	A2200030103120	① ② ③ ④ ⑤ ⑥ ⑦ ⑧	■
SFL 03010.03	NK 150	30	10	3	40	16.000	18.000	A2200030103150	① ② ③ ④ ⑤ ⑥ ⑦ ⑧	■
SFL 03010.03	NK 240	30	10	3	40	16.000	18.000	A2200030103240	① ② ③ ④ ⑤ ⑥ ⑦ ⑧	■
SFL 03010.03	NK 320	30	10	3	40	16.000	18.000	A2200030103320	① ② ③ ④ ⑤ ⑥ ⑦ ⑧	■
SFL 03010.06	NK 60	30	10	6	40	16.000	18.000	A2200030106060	① ② ③ ④ ⑤ ⑥ ⑦ ⑧	■
SFL 03010.06	NK 80	30	10	6	40	16.000	18.000	A2200030106080	① ② ③ ④ ⑤ ⑥ ⑦ ⑧	■
SFL 03010.06	NK 120	30	10	6	40	16.000	18.000	A2200030106120	① ② ③ ④ ⑤ ⑥ ⑦ ⑧	■
SFL 03010.06	NK 150	30	10	6	40	16.000	18.000	A2200030106150	① ② ③ ④ ⑤ ⑥ ⑦ ⑧	■
SFL 03010.06	NK 240	30	10	6	40	16.000	18.000	A2200030106240	① ② ③ ④ ⑤ ⑥ ⑦ ⑧	■
SFL 03010.06	NK 320	30	10	6	40	16.000	18.000	A2200030106320	① ② ③ ④ ⑤ ⑥ ⑦ ⑧	■
SFL 03015.06	NK 60	30	15	6	40	16.000	18.000	A2200030156060	① ② ③ ④ ⑤ ⑥ ⑦ ⑧	■
SFL 03015.06	NK 80	30	15	6	40	16.000	18.000	A2200030156080	① ② ③ ④ ⑤ ⑥ ⑦ ⑧	■
SFL 03015.06	NK 120	30	15	6	40	16.000	18.000	A2200030156120	① ② ③ ④ ⑤ ⑥ ⑦ ⑧	■
SFL 03015.06	NK 150	30	15	6	40	16.000	18.000	A2200030156150	① ② ③ ④ ⑤ ⑥ ⑦ ⑧	■
SFL 03020.06	NK 40	30	20	6	40	16.000	18.000	A2200030206040	① ② ③ ④ ⑤ ⑥ ⑦ ⑧	■
SFL 03020.06	NK 60	30	20	6	40	16.000	18.000	A2200030206060	① ② ③ ④ ⑤ ⑥ ⑦ ⑧	■
SFL 03020.06	NK 80	30	20	6	40	16.000	18.000	A2200030206080	① ② ③ ④ ⑤ ⑥ ⑦ ⑧	■
SFL 03020.06	NK 120	30	20	6	40	16.000	18.000	A2200030206120	① ② ③ ④ ⑤ ⑥ ⑦ ⑧	■
SFL 04010.03	NK 60	40	10	3	40	12.000	18.000	A2200040103060	① ② ③ ④ ⑤ ⑥ ⑦ ⑧	■
SFL 04010.03	NK 80	40	10	3	40	12.000	18.000	A2200040103080	① ② ③ ④ ⑤ ⑥ ⑦ ⑧	■
SFL 04010.03	NK 120	40	10	3	40	12.000	18.000	A2200040103120	① ② ③ ④ ⑤ ⑥ ⑦ ⑧	■
SFL 04010.03	NK 150	40	10	3	40	12.000	18.000	A2200040103150	① ② ③ ④ ⑤ ⑥ ⑦ ⑧	■
SFL 04010.06	NK 60	40	10	6	40	12.000	18.000	A2200040106060	① ② ③ ④ ⑤ ⑥ ⑦ ⑧	■
SFL 04010.06	NK 80	40	10	6	40	12.000	18.000	A2200040106080	① ② ③ ④ ⑤ ⑥ ⑦ ⑧	■
SFL 04010.06	NK 120	40	10	6	40	12.000	18.000	A2200040106120	① ② ③ ④ ⑤ ⑥ ⑦ ⑧	■
SFL 04010.06	NK 150	40	10	6	40	12.000	18.000	A2200040106150	① ② ③ ④ ⑤ ⑥ ⑦ ⑧	■

NEW

The stated maximum operating speed only applies to a maximum overhang L_0 of 20 mm. Other overhang dimensions must be calculated separately.

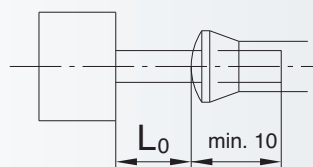

256 Mounted flap wheels of abrasive cloth



Industry

SFL, Flap wheels

Ordering example: A2200040106240

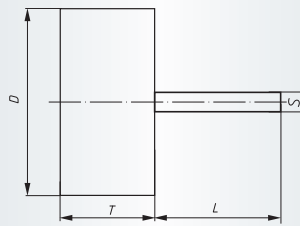
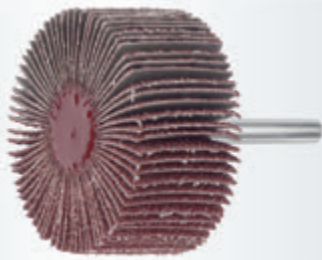

Packing unit:

10 pcs. per type

Further dimensions, qualities

and shank lengths on request

NK = reg. Aluminium Oxide

Description	Grits	D mm	T mm	S mm	L mm	n recom. (1/min)	n max. (1/min)	Product-Number	recommended for	
SFL 04010.06	NK 240	40	10	6	40	12.000	18.000	A2200040106240	1 2 3 4 5 6 7 8	■
SFL 04010.06	NK 320	40	10	6	40	12.000	18.000	A2200040106320	1 2 3 4 5 6 7 8	■
SFL 04015.06	NK 40	40	15	6	40	12.000	18.000	A2200040156040	1 2 3 4 5 6 7 8	■
SFL 04015.06	NK 60	40	15	6	40	12.000	18.000	A2200040156060	1 2 3 4 5 6 7 8	■
SFL 04015.06	NK 80	40	15	6	40	12.000	18.000	A2200040156080	1 2 3 4 5 6 7 8	■
SFL 04015.06	NK 120	40	15	6	40	12.000	18.000	A2200040156120	1 2 3 4 5 6 7 8	■
SFL 04015.06	NK 150	40	15	6	40	12.000	18.000	A2200040156150	1 2 3 4 5 6 7 8	■
SFL 04015.06	NK 240	40	15	6	40	12.000	18.000	A2200040156240	1 2 3 4 5 6 7 8	■
SFL 04015.06	NK 320	40	15	6	40	12.000	18.000	A2200040156320	1 2 3 4 5 6 7 8	■
SFL 04020.06	NK 40	40	20	6	40	12.000	18.000	A2200040206040	1 2 3 4 5 6 7 8	■
SFL 04020.06	NK 60	40	20	6	40	12.000	18.000	A2200040206060	1 2 3 4 5 6 7 8	■
SFL 04020.06	NK 80	40	20	6	40	12.000	18.000	A2200040206080	1 2 3 4 5 6 7 8	■
SFL 04020.06	NK 120	40	20	6	40	12.000	18.000	A2200040206120	1 2 3 4 5 6 7 8	■
SFL 04020.06	NK 150	40	20	6	40	12.000	18.000	A2200040206150	1 2 3 4 5 6 7 8	■
SFL 04020.06	NK 240	40	20	6	40	12.000	18.000	A2200040206240	1 2 3 4 5 6 7 8	■
SFL 04020.06	NK 320	40	20	6	40	12.000	18.000	A2200040206320	1 2 3 4 5 6 7 8	■
NEW SFL 04030.06	NK 40	40	30	6	40	12.000	18.000	A2200040306040	1 2 3 4 5 6 7 8	■
NEW SFL 04030.06	NK 60	40	30	6	40	12.000	18.000	A2200040306060	1 2 3 4 5 6 7 8	■
NEW SFL 04030.06	NK 80	40	30	6	40	12.000	18.000	A2200040306080	1 2 3 4 5 6 7 8	■
SFL 05010.06	NK 60	50	10	6	40	9.000	12.000	A2200050106060	1 2 3 4 5 6 7 8	■
SFL 05010.06	NK 80	50	10	6	40	9.000	12.000	A2200050106080	1 2 3 4 5 6 7 8	■
SFL 05010.06	NK 120	50	10	6	40	9.000	12.000	A2200050106120	1 2 3 4 5 6 7 8	■
SFL 05010.06	NK 150	50	10	6	40	9.000	12.000	A2200050106150	1 2 3 4 5 6 7 8	■
SFL 05010.06	NK 240	50	10	6	40	9.000	12.000	A2200050106240	1 2 3 4 5 6 7 8	■
SFL 05015.06	NK 40	50	15	6	40	9.000	12.000	A2200050156040	1 2 3 4 5 6 7 8	■
SFL 05015.06	NK 60	50	15	6	40	9.000	12.000	A2200050156060	1 2 3 4 5 6 7 8	■
SFL 05015.06	NK 80	50	15	6	40	9.000	12.000	A2200050156080	1 2 3 4 5 6 7 8	■
SFL 05015.06	NK 120	50	15	6	40	9.000	12.000	A2200050156120	1 2 3 4 5 6 7 8	■
SFL 05015.06	NK 150	50	15	6	40	9.000	12.000	A2200050156150	1 2 3 4 5 6 7 8	■
SFL 05015.06	NK 240	50	15	6	40	9.000	12.000	A2200050156240	1 2 3 4 5 6 7 8	■
SFL 05015.06	NK 320	50	15	6	40	9.000	12.000	A2200050156320	1 2 3 4 5 6 7 8	■
SFL 05020.06	NK 40	50	20	6	40	9.000	12.000	A2200050206040	1 2 3 4 5 6 7 8	■

The stated maximum operating speed only applies to a maximum overhang L_0 of 20 mm. Other overhang dimensions must be calculated separately.

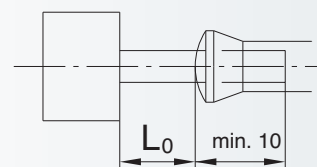



Industry

SFL, Flap wheels

Ordering example: A2200050206060

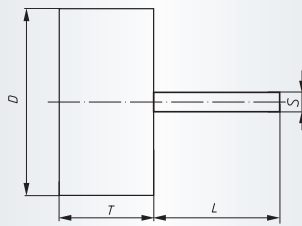
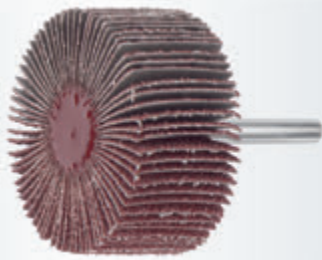

Packing unit:

10 pcs. per type

Further dimensions, qualities

and shank lengths on request

NK = reg. Aluminium Oxide

Description	Grits	D mm	T mm	S mm	L mm	n recom. (1/min)	n max. (1/min)	Product-Number	recommended for	
SFL 05020.06	NK 60	50	20	6	40	9.000	12.000	A2200050206060	① ② ③ ④ ⑤ ⑥ ⑦ ⑧	■
SFL 05020.06	NK 80	50	20	6	40	9.000	12.000	A2200050206080	① ② ③ ④ ⑤ ⑥ ⑦ ⑧	■
SFL 05020.06	NK 120	50	20	6	40	9.000	12.000	A2200050206120	① ② ③ ④ ⑤ ⑥ ⑦ ⑧	■
SFL 05020.06	NK 150	50	20	6	40	9.000	12.000	A2200050206150	① ② ③ ④ ⑤ ⑥ ⑦ ⑧	■
SFL 05020.06	NK 240	50	20	6	40	9.000	12.000	A2200050206240	① ② ③ ④ ⑤ ⑥ ⑦ ⑧	■
SFL 05020.06	NK 320	50	20	6	40	9.000	12.000	A2200050206320	① ② ③ ④ ⑤ ⑥ ⑦ ⑧	■
SFL 05030.06	NK 40	50	30	6	40	9.000	12.000	A2200050306040	① ② ③ ④ ⑤ ⑥ ⑦ ⑧	■
SFL 05030.06	NK 60	50	30	6	40	9.000	12.000	A2200050306060	① ② ③ ④ ⑤ ⑥ ⑦ ⑧	■
SFL 05030.06	NK 80	50	30	6	40	9.000	12.000	A2200050306080	① ② ③ ④ ⑤ ⑥ ⑦ ⑧	■
SFL 05030.06	NK 120	50	30	6	40	9.000	12.000	A2200050306120	① ② ③ ④ ⑤ ⑥ ⑦ ⑧	■
SFL 05030.06	NK 150	50	30	6	40	9.000	12.000	A2200050306150	① ② ③ ④ ⑤ ⑥ ⑦ ⑧	■
SFL 05030.06	NK 320	50	30	6	40	9.000	12.000	A2200050306320	① ② ③ ④ ⑤ ⑥ ⑦ ⑧	■
SFL 06010.06	NK 60	60	10	6	40	8.000	12.000	A2200060106060	① ② ③ ④ ⑤ ⑥ ⑦ ⑧	■
SFL 06010.06	NK 80	60	10	6	40	8.000	12.000	A2200060106080	① ② ③ ④ ⑤ ⑥ ⑦ ⑧	■
SFL 06015.06	NK 40	60	15	6	40	8.000	12.000	A2200060156040	① ② ③ ④ ⑤ ⑥ ⑦ ⑧	■
SFL 06015.06	NK 60	60	15	6	40	8.000	12.000	A2200060156060	① ② ③ ④ ⑤ ⑥ ⑦ ⑧	■
SFL 06015.06	NK 80	60	15	6	40	8.000	12.000	A2200060156080	① ② ③ ④ ⑤ ⑥ ⑦ ⑧	■
SFL 06015.06	NK 120	60	15	6	40	8.000	12.000	A2200060156120	① ② ③ ④ ⑤ ⑥ ⑦ ⑧	■
SFL 06015.06	NK 150	60	15	6	40	8.000	12.000	A2200060156150	① ② ③ ④ ⑤ ⑥ ⑦ ⑧	■
SFL 06015.06	NK 240	60	15	6	40	8.000	12.000	A2200060156240	① ② ③ ④ ⑤ ⑥ ⑦ ⑧	■
SFL 06015.06	NK 320	60	15	6	40	8.000	12.000	A2200060156320	① ② ③ ④ ⑤ ⑥ ⑦ ⑧	■
SFL 06020.06	NK 40	60	20	6	40	8.000	12.000	A2200060206040	① ② ③ ④ ⑤ ⑥ ⑦ ⑧	■
SFL 06020.06	NK 60	60	20	6	40	8.000	12.000	A2200060206060	① ② ③ ④ ⑤ ⑥ ⑦ ⑧	■
SFL 06020.06	NK 80	60	20	6	40	8.000	12.000	A2200060206080	① ② ③ ④ ⑤ ⑥ ⑦ ⑧	■
SFL 06020.06	NK 120	60	20	6	40	8.000	12.000	A2200060206120	① ② ③ ④ ⑤ ⑥ ⑦ ⑧	■
SFL 06020.06	NK 150	60	20	6	40	8.000	12.000	A2200060206150	① ② ③ ④ ⑤ ⑥ ⑦ ⑧	■
SFL 06020.06	NK 240	60	20	6	40	8.000	12.000	A2200060206240	① ② ③ ④ ⑤ ⑥ ⑦ ⑧	■
SFL 06020.06	NK 320	60	20	6	40	8.000	12.000	A2200060206320	① ② ③ ④ ⑤ ⑥ ⑦ ⑧	■
SFL 06030.06	NK 40	60	30	6	40	8.000	12.000	A2200060306040	① ② ③ ④ ⑤ ⑥ ⑦ ⑧	■
SFL 06030.06	NK 60	60	30	6	40	8.000	12.000	A2200060306060	① ② ③ ④ ⑤ ⑥ ⑦ ⑧	■
SFL 06030.06	NK 80	60	30	6	40	8.000	12.000	A2200060306080	① ② ③ ④ ⑤ ⑥ ⑦ ⑧	■
SFL 06030.06	NK 120	60	30	6	40	8.000	12.000	A2200060306120	① ② ③ ④ ⑤ ⑥ ⑦ ⑧	■

NEW

NEW

NEW

The stated maximum operating speed only applies to a maximum overhang L_0 of 20 mm. Other overhang dimensions must be calculated separately.

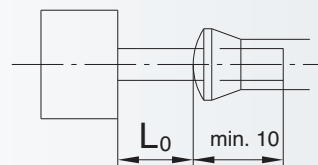

258 Mounted flap wheels of abrasive cloth



Industry

SFL, Flap wheels

Ordering example: A2200060306150

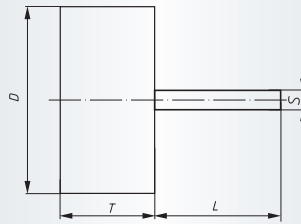
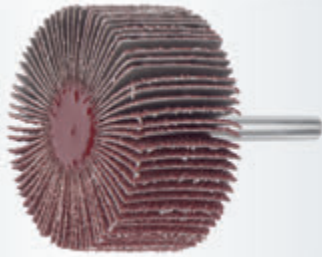

Packing unit:

10 pcs. per type

Further dimensions, qualities

and shank lengths on request

NK = reg. Aluminium Oxide

Description	Grits	D mm	T mm	S mm	L mm	n recom. (1/min)	n max. (1/min)	Product-Number	recommended for	
SFL 06030.06	NK 150	60	30	6	40	8.000	12.000	A2200060306150	1 2 3 4 5 6 7 8	■
SFL 06030.06	NK 240	60	30	6	40	8.000	12.000	A2200060306240	1 2 3 4 5 6 7 8	■
SFL 06030.06	NK 320	60	30	6	40	8.000	12.000	A2200060306320	1 2 3 4 5 6 7 8	■
SFL 06040.06	NK 40	60	40	6	40	8.000	12.000	A2200060406040	1 2 3 4 5 6 7 8	■
SFL 06040.06	NK 60	60	40	6	40	8.000	12.000	A2200060406060	1 2 3 4 5 6 7 8	■
SFL 06040.06	NK 80	60	40	6	40	8.000	12.000	A2200060406080	1 2 3 4 5 6 7 8	■
SFL 06040.06	NK 120	60	40	6	40	8.000	12.000	A2200060406120	1 2 3 4 5 6 7 8	■
SFL 06040.06	NK 150	60	40	6	40	8.000	12.000	A2200060406150	1 2 3 4 5 6 7 8	■
SFL 06040.06	NK 240	60	40	6	40	8.000	12.000	A2200060406240	1 2 3 4 5 6 7 8	■
SFL 06040.06	NK 320	60	40	6	40	8.000	12.000	A2200060406320	1 2 3 4 5 6 7 8	■
NEW SFL 06050.06	NK 40	60	50	6	40	8.000	8.500	A2200060506040	1 2 3 4 5 6 7 8	■
SFL 06050.06	NK 60	60	50	6	40	8.000	8.500	A2200060506060	1 2 3 4 5 6 7 8	■
SFL 06050.06	NK 80	60	50	6	40	8.000	8.500	A2200060506080	1 2 3 4 5 6 7 8	■
SFL 06050.06	NK 120	60	50	6	40	8.000	8.500	A2200060506120	1 2 3 4 5 6 7 8	■
SFL 06050.06	NK 150	60	50	6	40	8.000	8.500	A2200060506150	1 2 3 4 5 6 7 8	■
SFL 06050.06	NK 240	60	50	6	40	8.000	8.500	A2200060506240	1 2 3 4 5 6 7 8	■
SFL 08015.06	NK 60	80	15	6	40	6.000	9.000	A2200080156060	1 2 3 4 5 6 7 8	■
SFL 08015.06	NK 80	80	15	6	40	6.000	9.000	A2200080156080	1 2 3 4 5 6 7 8	■
SFL 08015.06	NK 120	80	15	6	40	6.000	9.000	A2200080156120	1 2 3 4 5 6 7 8	■
SFL 08015.06	NK 150	80	15	6	40	6.000	9.000	A2200080156150	1 2 3 4 5 6 7 8	■
SFL 08015.06	NK 240	80	15	6	40	6.000	9.000	A2200080156240	1 2 3 4 5 6 7 8	■
SFL 08015.06	NK 320	80	15	6	40	6.000	9.000	A2200080156320	1 2 3 4 5 6 7 8	■
SFL 08020.06	NK 60	80	20	6	40	6.000	9.000	A2200080206060	1 2 3 4 5 6 7 8	■
SFL 08020.06	NK 80	80	20	6	40	6.000	9.000	A2200080206080	1 2 3 4 5 6 7 8	■
SFL 08020.06	NK 120	80	20	6	40	6.000	9.000	A2200080206120	1 2 3 4 5 6 7 8	■
SFL 08020.06	NK 150	80	20	6	40	6.000	9.000	A2200080206150	1 2 3 4 5 6 7 8	■
SFL 08030.06	NK 40	80	30	6	40	6.000	9.000	A2200080306040	1 2 3 4 5 6 7 8	■
SFL 08030.06	NK 60	80	30	6	40	6.000	9.000	A2200080306060	1 2 3 4 5 6 7 8	■
SFL 08030.06	NK 80	80	30	6	40	6.000	9.000	A2200080306080	1 2 3 4 5 6 7 8	■
SFL 08030.06	NK 120	80	30	6	40	6.000	9.000	A2200080306120	1 2 3 4 5 6 7 8	■
SFL 08030.06	NK 150	80	30	6	40	6.000	9.000	A2200080306150	1 2 3 4 5 6 7 8	■
SFL 08030.06	NK 320	80	30	6	40	6.000	9.000	A2200080306320	1 2 3 4 5 6 7 8	■

The stated maximum operating speed only applies to a maximum overhang L_0 of 20 mm. Other overhang dimensions must be calculated separately.

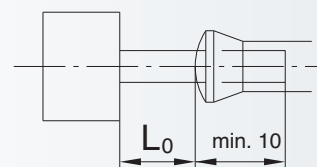



SFL, Flap wheels

Ordering example: A2200080406060

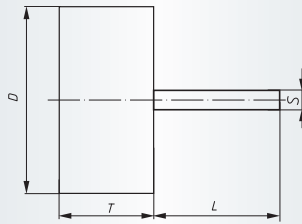
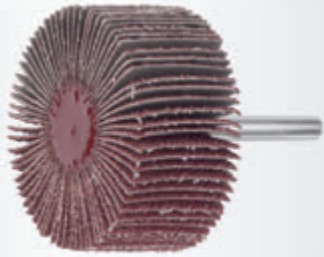

Packing unit:

10 pcs. per type

Further dimensions, qualities

and shank lengths on request

NK = reg. Aluminium Oxide

Description	Grits	D mm	T mm	S mm	L mm	n recom. (1/min)	n max. (1/min)	Product-Number	recommended for	
SFL 08040.06	NK 60	80	40	6	40	6.000	9.000	A2200080406060	① ② ③ ④ ⑤ ⑥ ⑦ ⑧	■
SFL 08040.06	NK 80	80	40	6	40	6.000	9.000	A2200080406080	① ② ③ ④ ⑤ ⑥ ⑦ ⑧	■
SFL 08040.06	NK 150	80	40	6	40	6.000	9.000	A2200080406150	① ② ③ ④ ⑤ ⑥ ⑦ ⑧	■
SFL 08050.06	NK 40	80	50	6	40	6.000	7.500	A2200080506040	① ② ③ ④ ⑤ ⑥ ⑦ ⑧	■
SFL 08050.06	NK 60	80	50	6	40	6.000	7.500	A2200080506060	① ② ③ ④ ⑤ ⑥ ⑦ ⑧	■
SFL 08050.06	NK 80	80	50	6	40	6.000	7.500	A2200080506080	① ② ③ ④ ⑤ ⑥ ⑦ ⑧	■
SFL 08050.06	NK 120	80	50	6	40	6.000	7.500	A2200080506120	① ② ③ ④ ⑤ ⑥ ⑦ ⑧	■
SFL 08050.06	NK 150	80	50	6	40	6.000	7.500	A2200080506150	① ② ③ ④ ⑤ ⑥ ⑦ ⑧	■
SFL 08050.06	NK 240	80	50	6	40	6.000	7.500	A2200080506240	① ② ③ ④ ⑤ ⑥ ⑦ ⑧	■
SFL 08050.06	NK 320	80	50	6	40	6.000	7.500	A2200080506320	① ② ③ ④ ⑤ ⑥ ⑦ ⑧	■
SFL 10040.08	NK 40	100	40	8	40	5.000	7.500	A2200100408040	① ② ③ ④ ⑤ ⑥ ⑦ ⑧	■
SFL 10040.08	NK 60	100	40	8	40	5.000	7.500	A2200100408060	① ② ③ ④ ⑤ ⑥ ⑦ ⑧	■
SFL 10050.08	NK 60	100	50	8	40	5.000	7.500	A2200100508060	① ② ③ ④ ⑤ ⑥ ⑦ ⑧	■
SFL 10050.08	NK 80	100	50	8	40	5.000	7.500	A2200100508080	① ② ③ ④ ⑤ ⑥ ⑦ ⑧	■
SFL 10050.08	NK 150	100	50	8	40	5.000	7.500	A2200100508150	① ② ③ ④ ⑤ ⑥ ⑦ ⑧	■

The stated maximum operating speed only applies to a maximum overhang L_0 of 20 mm. Other overhang dimensions must be calculated separately.

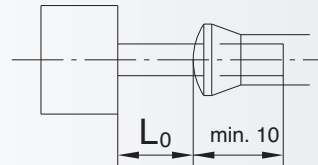

260 Mounted flap wheels of abrasive cloth



Industry

SFB, Slotted flap wheel

Ordering example: A2220040206080

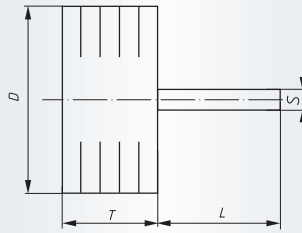

Packing unit:

10 pcs. per type

Further dimensions, qualities

and shank lengths on request

NK = reg. Aluminium Oxide

Description	Grits	D mm	T mm	S mm	L mm	n recom. (1/min)	n max. (1/min)	Product-Number	recommended for	
SFB 04020.06	NK 80	40	20	6	40	12.000	18.000	A2220040206080	① ② ③ ④ ⑤ ⑥ ⑦ ⑧	■
SFB 05020.06	NK 80	50	20	6	40	9.000	12.000	A2220050206080	① ② ③ ④ ⑤ ⑥ ⑦ ⑧	■
SFB 05030.06	NK 120	50	30	6	40	9.000	12.000	A2220050306120	① ② ③ ④ ⑤ ⑥ ⑦ ⑧	■
SFB 06030.06	NK 80	60	30	6	40	8.000	12.000	A2220060306080	① ② ③ ④ ⑤ ⑥ ⑦ ⑧	■
SFB 06030.06	NK 120	60	30	6	40	8.000	12.000	A2220060306120	① ② ③ ④ ⑤ ⑥ ⑦ ⑧	■

By slotting the lamellas on the periphery, the flexibility of this type of mounted wheel is increased. The slotted flap wheel quickly profiles itself to the contour of the workpiece. For special dimensions and grit sizes minimum quantity on request.

The stated maximum operating speed only applies to a maximum overhang L_0 of 20 mm. Other overhang dimensions must be calculated separately.

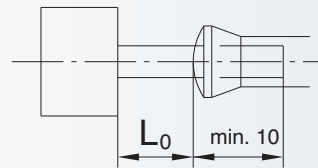



SFE, Flap wheels of abrasive cloth, regular aluminium oxide, special bond

Ordering example: A2201030103120

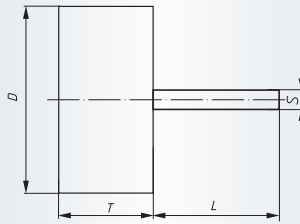
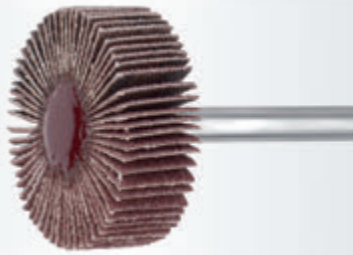

Packing unit:

10 pcs. per type

Further dimensions, qualities and shank lengths on request

NKE = reg. Aluminium Oxide with a coating of active grinding additives

Description	Grits	D mm	T mm	S mm	L mm	n recom. (1/min)	n max. (1/min)	Product-Number	recommended for	
SFE 03010.03	NKE 120	30	10	3	40	16.000	18.000	A2201030103120	① ② ③ ④ ⑤ ⑥ ⑦ ⑧	■
SFE 03010.06	NKE 60	30	10	6	40	16.000	18.000	A2201030106060	① ② ③ ④ ⑤ ⑥ ⑦ ⑧	■
SFE 03010.06	NKE 80	30	10	6	40	16.000	18.000	A2201030106080	① ② ③ ④ ⑤ ⑥ ⑦ ⑧	■
SFE 03010.06	NKE 150	30	10	6	40	16.000	18.000	A2201030106150	① ② ③ ④ ⑤ ⑥ ⑦ ⑧	■
SFE 04015.06	NKE 60	40	15	6	40	12.000	18.000	A2201040156060	① ② ③ ④ ⑤ ⑥ ⑦ ⑧	■
SFE 04015.06	NKE 80	40	15	6	40	12.000	18.000	A2201040156080	① ② ③ ④ ⑤ ⑥ ⑦ ⑧	■
SFE 04015.06	NKE 120	40	15	6	40	12.000	18.000	A2201040156120	① ② ③ ④ ⑤ ⑥ ⑦ ⑧	■
SFE 05015.06	NKE 80	50	15	6	40	9.000	12.000	A2201050156080	① ② ③ ④ ⑤ ⑥ ⑦ ⑧	■
SFE 05015.06	NKE 150	50	15	6	40	9.000	12.000	A2201050156150	① ② ③ ④ ⑤ ⑥ ⑦ ⑧	■
SFE 06020.06	NKE 80	60	20	6	40	8.000	12.000	A2201060206080	① ② ③ ④ ⑤ ⑥ ⑦ ⑧	■
SFE 06030.06	NKE 60	60	30	6	40	8.000	12.000	A2201060306060	① ② ③ ④ ⑤ ⑥ ⑦ ⑧	■
SFE 06030.06	NKE 80	60	30	6	40	8.000	12.000	A2201060306080	① ② ③ ④ ⑤ ⑥ ⑦ ⑧	■
SFE 06030.06	NKE 120	60	30	6	40	8.000	12.000	A2201060306120	① ② ③ ④ ⑤ ⑥ ⑦ ⑧	■
SFE 06030.06	NKE 150	60	30	6	40	8.000	12.000	A2201060306150	① ② ③ ④ ⑤ ⑥ ⑦ ⑧	■
SFE 06050.06	NKE 60	60	50	6	40	8.000	8.500	A2201060506060	① ② ③ ④ ⑤ ⑥ ⑦ ⑧	■
SFE 06050.06	NKE 120	60	50	6	40	8.000	8.500	A2201060506120	① ② ③ ④ ⑤ ⑥ ⑦ ⑧	■
SFE 08030.06	NKE 80	80	30	6	40	6.000	9.000	A2201080306080	① ② ③ ④ ⑤ ⑥ ⑦ ⑧	■
SFE 08050.06	NKE 80	80	50	6	40	6.000	7.500	A2201080506080	① ② ③ ④ ⑤ ⑥ ⑦ ⑧	■

The stated maximum operating speed only applies to a maximum overhang L_0 of 20 mm. Other overhang dimensions must be calculated separately.

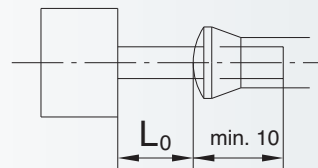

262 Mounted flap wheels of abrasive cloth



Industry

SFC, Flap wheels of abrasive cloth, silicon carbide

Ordering example: A2202030106080

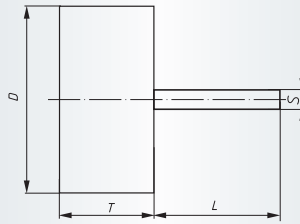
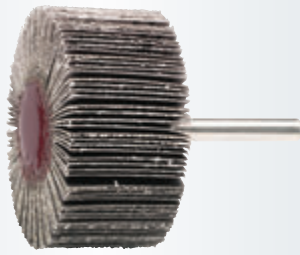

Packing unit:

10 pcs. per type

Further dimensions, qualities and shank lengths on request

SIC = silicon carbide

Description	Grits	D mm	T mm	S mm	L mm	n recom. (1/min)	n max. (1/min)	Product-Number	recommended for	
SFC 03010.06	SIC 80	30	10	6	40	16.000	18.000	A2202030106080	① ② ③ ④ ⑤ ⑥ ⑦ ⑧ ⑨	■
SFC 03010.06	SIC 150	30	10	6	40	16.000	18.000	A2202030106150	① ② ③ ④ ⑤ ⑥ ⑦ ⑧ ⑨	■
SFC 04015.06	SIC 80	40	15	6	40	12.000	18.000	A2202040156080	① ② ③ ④ ⑤ ⑥ ⑦ ⑧ ⑨	■
SFC 06020.06	SIC 80	60	20	6	40	8.000	12.000	A2202060206080	① ② ③ ④ ⑤ ⑥ ⑦ ⑧ ⑨	■
SFC 06020.06	SIC 120	60	20	6	40	8.000	12.000	A2202060206120	① ② ③ ④ ⑤ ⑥ ⑦ ⑧ ⑨	■
SFC 06030.06	SIC 120	60	30	6	40	8.000	12.000	A2202060306120	① ② ③ ④ ⑤ ⑥ ⑦ ⑧ ⑨	■

The stated maximum operating speed only applies to a maximum overhang L_0 of 20 mm. Other overhang dimensions must be calculated separately.

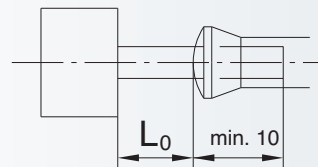

264 Mounted flap wheels of abrasive cloth with thread



Industry

SFA, Flap wheels of abrasive cloth, with external thread

Ordering example: A2200015055150

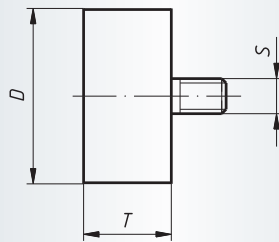

Packing unit:

10 pcs. per type

Further dimensions and qualities on request.

NK = reg. Aluminium Oxide

Description	Grits	D mm	T mm	Thread S	n recom. (1/min)	n max. (1/min)	Product-Number	recommended for	
SFA 01505.M5	NK 150	15	5	M5	16.000	18.000	A2200015055150	① ② ③ ④ ⑤ ⑥ ⑦ ⑧	■
SFA 01505.M5	NK 240	15	5	M5	16.000	18.000	A2200015055240	① ② ③ ④ ⑤ ⑥ ⑦ ⑧	■
SFA 02005.M5	NK 150	20	5	M5	16.000	18.000	A2200020055150	① ② ③ ④ ⑤ ⑥ ⑦ ⑧	■
SFA 02005.M5	NK 240	20	5	M5	16.000	18.000	A2200020055240	① ② ③ ④ ⑤ ⑥ ⑦ ⑧	■
SFA 03005.M5	NK 120	30	5	M5	16.000	18.000	A2200030055120	① ② ③ ④ ⑤ ⑥ ⑦ ⑧	■
SFA 03005.M5	NK 150	30	5	M5	16.000	18.000	A2200030055150	① ② ③ ④ ⑤ ⑥ ⑦ ⑧	■
SFA 03005.M5	NK 240	30	5	M5	16.000	18.000	A2200030055240	① ② ③ ④ ⑤ ⑥ ⑦ ⑧	■

The stated maximum permissible operating speed is only valid if the correct tool adaptor is used (see table).



Industry

Adaptor for SFA

Ordering example: A36300518

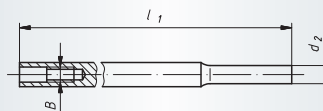

Packing unit:

1 pc. per type

Description	d2 mm	l1 mm	B mm	Product-Number		
WADA 05	6	100	M5	A36300518		■



MFS, Mini-Flap wheels of abrasive cloth

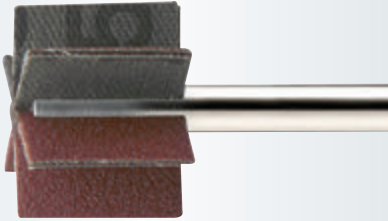

Applications:

- Deburring of drill holes
- Production and cleaning of moulds for glass-industry
- Inside processing/machining of tubes
- Processing of light alloy rims
- Processing of the borings of turbine blades
- Manifold special applications

Advantages:

- Possibility of fine-grinding and finishing work
- The arrangement of the lamellars ensure high flexibility
- Good circulation of air and though cold grinding
- Processing of small borings and inner-diameters of tubes

Mini-Flap wheels with a diameter of 10–30 mm are available with different shank lengths and qualities.

available on request

Always the right tool



Filing ring: I take pride in having been involved in the development process for this thin-walled tool, starting out from a forged tool steel blank up to the finished toothed filing ring.

Bajram Loshaj
Engineering Department

www.lukas-erzett.com

Notes

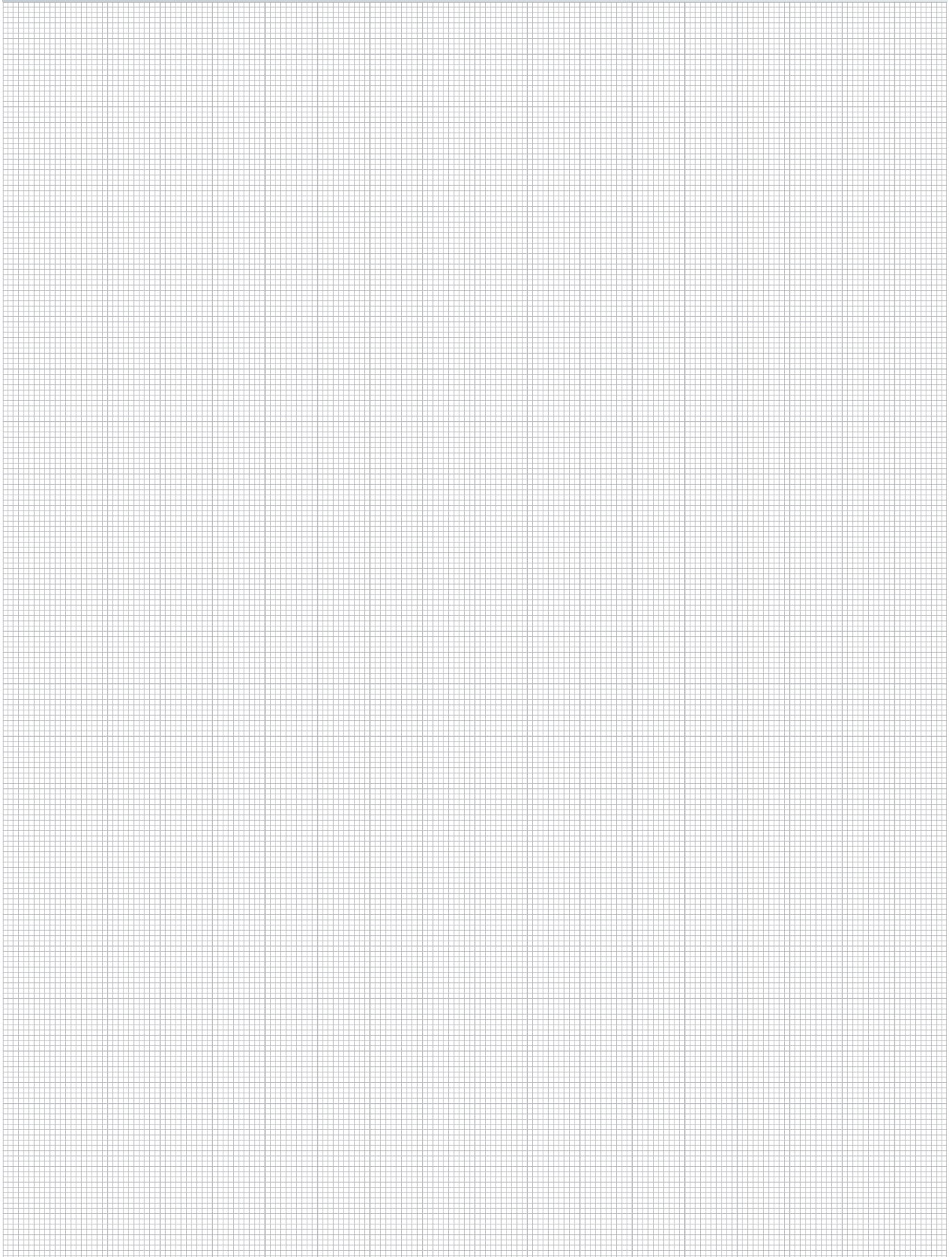
A large, empty grid area for taking notes, consisting of a fine grid of small squares. A solid green vertical bar is located on the left edge of the page, partially overlapping the grid.