

Flap wheels and long rolls

| | |
|------------|---|
| 222 | Qualities and Applications |
| 278 | General Information |
| 279 | Flap wheels of abrasive cloth |
| 280 | Flap wheels of abrasive cloth for angle grinder |
| 283 | Flap wheels of abrasive fleece/ abrasive cloth combination |
| 285 | Fleece mops |
| 285 | Rolls manufactured of abrasive fleece |

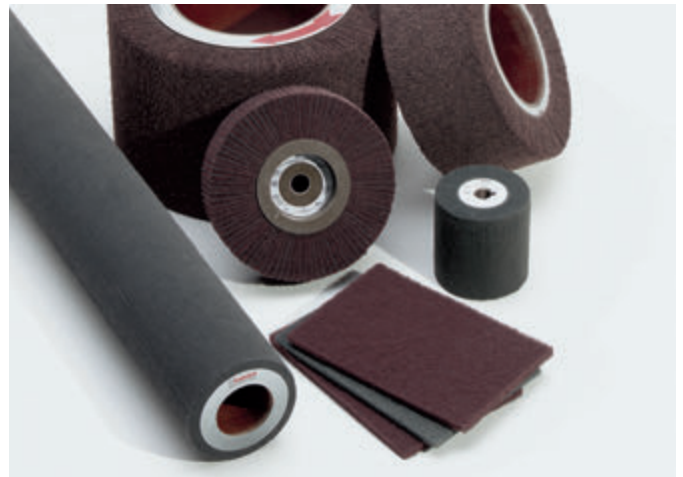

Product line marking

Product lines are labelled in the table header with the appropriate tabs. Further information on page **14** and **15**.

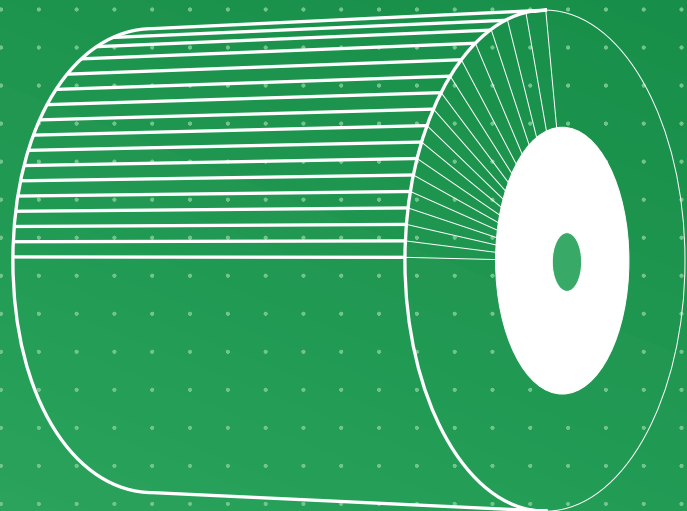

Information

LSL, Flap Wheels of abrasive cloth (tailor-made solution)

These wheels with various bore dimensions can be used on both hand-held and floor-stand type machines. The type LSL consists of individual flaps imbedded radially into a very substantial resin-based core.

Please take note of the rotational direction!

Examples of application:

- preparation work
- deburring
- de-rusting
- prefinishing
- graining
- keying

LSL, Flap Wheels of abrasive cloth for angle grinder

Advantages:

- Fits onto standard angle grinders
- Replaces the use of shaft mounted flap wheels (where no straight grinder is available)
- No flange needed
- Ideal for welding seams on Stainless Steel (tanks)

Examples of application:

- de-rusting, removal of surface coatings and oxidized layers
- cleaning of welding seams
- grinding in the tank industry and construction of railings
- grinding in the assembling industry

Application info:

Only to be used on the periphery of the wheel

LSV, Grinding wheels of abrasive fleece (tailor-made solution)

These wheels with various bore dimensions can be used on both hand-held and floor-stand type machines. The LSV consists of abrasive impregnated fleece flaps. A special type of fleece gives flexibility to the tools which easily conforms to the individual workpiece profile.

Examples of application:

- matting
- conditioning
- polishing
- finishing
- final surface finishing

LSM, Flap wheels of abrasive fleece with abrasive cloth (tailor-made solution)

These wheels with various bore dimensions can be used on both hand-held and floor-stand type machines.

Due to the combination of coated abrasive and abrasive fleece greater stock removal is achieved compared to the product type LSV. Please take note of the rotational direction!

Examples of application:

- preparation work
- de-rusting
- pre-finishing
- graining
- keying



LSL, Flap Wheels of abrasive cloth, tailor-made solution

Ordering example: LSL 125025 NK 60 Bore 13

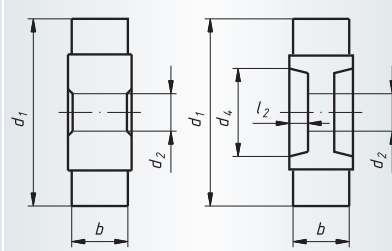

Packing unit:

Minimum ordering quantity 25 pcs. per type

$v_{rec.}$: 30 m/s off-hand application

$v_{max.}$: 50 m/s for stationary machines

* for stationary machines

Other dimensions can be supplied on request – from 80 mm to max. 400 mm.

NK = reg. Aluminium Oxide

| Description | Grits | d ₁ mm | b mm | Bore d ₂ mm | recess on both sides d ₄ mm | recess on both sides l ₂ mm | n recom. (1/min) | n max. * (1/min) | recommended for | |
|-------------|--------|-------------------|------|------------------------|--|--|------------------|------------------|-----------------|---|
| LSL 125025 | NK 60 | 125 | 25 | 13-16-20 | --- | --- | 4.500 | 7.600 | ① ② ③ ④ ⑤ ⑥ ⑦ ⑧ | ■ |
| LSL 125025 | NK 80 | 125 | 25 | 13-16-20 | --- | --- | 4.500 | 7.600 | ① ② ③ ④ ⑤ ⑥ ⑦ ⑧ | ■ |
| LSL 125025 | NK 120 | 125 | 25 | 13-16-20 | --- | --- | 4.500 | 7.600 | ① ② ③ ④ ⑤ ⑥ ⑦ ⑧ | ■ |
| LSL 125025 | NK 150 | 125 | 25 | 13-16-20 | --- | --- | 4.500 | 7.600 | ① ② ③ ④ ⑤ ⑥ ⑦ ⑧ | ■ |
| LSL 125025 | NK 240 | 125 | 25 | 13-16-20 | --- | --- | 4.500 | 7.600 | ① ② ③ ④ ⑤ ⑥ ⑦ ⑧ | ■ |
| LSL 150050 | NK 60 | 150 | 50 | 13-16-20 | 47 | 18 | 3.800 | 6.300 | ① ② ③ ④ ⑤ ⑥ ⑦ ⑧ | ■ |
| LSL 150050 | NK 80 | 150 | 50 | 13-16-20 | 47 | 18 | 3.800 | 6.300 | ① ② ③ ④ ⑤ ⑥ ⑦ ⑧ | ■ |
| LSL 150050 | NK 120 | 150 | 50 | 13-16-20 | 47 | 18 | 3.800 | 6.300 | ① ② ③ ④ ⑤ ⑥ ⑦ ⑧ | ■ |
| LSL 150050 | NK 150 | 150 | 50 | 13-16-20 | 47 | 18 | 3.800 | 6.300 | ① ② ③ ④ ⑤ ⑥ ⑦ ⑧ | ■ |
| LSL 150050 | NK 240 | 150 | 50 | 13-16-20 | 47 | 18 | 3.800 | 6.300 | ① ② ③ ④ ⑤ ⑥ ⑦ ⑧ | ■ |
| LSL 165050 | NK 60 | 165 | 50 | 13-16-20 | 47 | 18 | 3.400 | 5.700 | ① ② ③ ④ ⑤ ⑥ ⑦ ⑧ | ■ |
| LSL 165050 | NK 80 | 165 | 50 | 13-16-20 | 47 | 18 | 3.400 | 5.700 | ① ② ③ ④ ⑤ ⑥ ⑦ ⑧ | ■ |
| LSL 165050 | NK 120 | 165 | 50 | 13-16-20 | 47 | 18 | 3.400 | 5.700 | ① ② ③ ④ ⑤ ⑥ ⑦ ⑧ | ■ |
| LSL 165050 | NK 150 | 165 | 50 | 13-16-20 | 47 | 18 | 3.400 | 5.700 | ① ② ③ ④ ⑤ ⑥ ⑦ ⑧ | ■ |
| LSL 165050 | NK 240 | 165 | 50 | 13-16-20 | 47 | 18 | 3.400 | 5.700 | ① ② ③ ④ ⑤ ⑥ ⑦ ⑧ | ■ |
| LSL 200025 | NK 60 | 200 | 25 | 20-25-32 | 71 | 10 | 2.800 | 4.700 | ① ② ③ ④ ⑤ ⑥ ⑦ ⑧ | ■ |
| LSL 200025 | NK 80 | 200 | 25 | 20-25-32 | 71 | 10 | 2.800 | 4.700 | ① ② ③ ④ ⑤ ⑥ ⑦ ⑧ | ■ |
| LSL 200025 | NK 120 | 200 | 25 | 20-25-32 | 71 | 10 | 2.800 | 4.700 | ① ② ③ ④ ⑤ ⑥ ⑦ ⑧ | ■ |
| LSL 200025 | NK 150 | 200 | 25 | 20-25-32 | 71 | 10 | 2.800 | 4.700 | ① ② ③ ④ ⑤ ⑥ ⑦ ⑧ | ■ |
| LSL 200025 | NK 240 | 200 | 25 | 20-25-32 | 71 | 10 | 2.800 | 4.700 | ① ② ③ ④ ⑤ ⑥ ⑦ ⑧ | ■ |
| LSL 200050 | NK 60 | 200 | 50 | 20-25-32 | 71 | 18 | 2.800 | 4.700 | ① ② ③ ④ ⑤ ⑥ ⑦ ⑧ | ■ |
| LSL 200050 | NK 80 | 200 | 50 | 20-25-32 | 71 | 18 | 2.800 | 4.700 | ① ② ③ ④ ⑤ ⑥ ⑦ ⑧ | ■ |
| LSL 200050 | NK 120 | 200 | 50 | 20-25-32 | 71 | 18 | 2.800 | 4.700 | ① ② ③ ④ ⑤ ⑥ ⑦ ⑧ | ■ |
| LSL 200050 | NK 150 | 200 | 50 | 20-25-32 | 71 | 18 | 2.800 | 4.700 | ① ② ③ ④ ⑤ ⑥ ⑦ ⑧ | ■ |
| LSL 200050 | NK 240 | 200 | 50 | 20-25-32 | 71 | 18 | 2.800 | 4.700 | ① ② ③ ④ ⑤ ⑥ ⑦ ⑧ | ■ |

280 Flap Wheels of abrasive cloth and abrasive fleece



Industry

LSL, Flap Wheels of abrasive cloth for angle grinder

Ordering example: A2280125200040

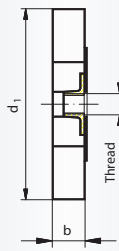

Packing unit:

5 pcs. per type

v_{max} : 80 m/s

NK = reg. Aluminium Oxide

| Description | Grits | d ₁ mm | b mm | Thread | n recom. (1/min) | n max. (1/min) | Product-Number | recommended for | |
|-----------------------|--------|-------------------|------|--------|------------------|----------------|-------------------|-----------------|---|
| LSL 125020 | NK 40 | 125 | 20 | M14 | 9.600 | 12.200 | A2280125200040 | ① ② ③ ④ ⑤ ⑥ ⑦ ⑧ | ■ |
| NEW LSL 125020 | NK 40 | 125 | 20 | 5/8" | 9.600 | 12.200 | A2280125200040001 | ① ② ③ ④ ⑤ ⑥ ⑦ ⑧ | ■ |
| LSL 125020 | NK 60 | 125 | 20 | M14 | 9.600 | 12.200 | A2280125200060 | ① ② ③ ④ ⑤ ⑥ ⑦ ⑧ | ■ |
| NEW LSL 125020 | NK 60 | 125 | 20 | 5/8" | 9.600 | 12.200 | A2280125200060001 | ① ② ③ ④ ⑤ ⑥ ⑦ ⑧ | ■ |
| LSL 125020 | NK 80 | 125 | 20 | M14 | 9.600 | 12.200 | A2280125200080 | ① ② ③ ④ ⑤ ⑥ ⑦ ⑧ | ■ |
| NEW LSL 125020 | NK 80 | 125 | 20 | 5/8" | 9.600 | 12.200 | A2280125200080001 | ① ② ③ ④ ⑤ ⑥ ⑦ ⑧ | ■ |
| LSL 125020 | NK 120 | 125 | 20 | M14 | 9.600 | 12.200 | A2280125200120 | ① ② ③ ④ ⑤ ⑥ ⑦ ⑧ | ■ |
| NEW LSL 125020 | NK 120 | 125 | 20 | 5/8" | 9.600 | 12.200 | A2280125200120001 | ① ② ③ ④ ⑤ ⑥ ⑦ ⑧ | ■ |

Advantages:

- Fits onto standard angle grinders
- Replaces the use of shaft mounted flap wheels (where no straight grinder is available)
- No flange needed
- Ideal for welding seams on Stainless Steel (tanks)

Application examples:

- De-rusting, removal of surface coatings and oxidise layers
- Cleaning of welding seams
- Grinding in the tank industry
- Grinding in the assembling industry

Application info:

Only to be used on the periphery of the wheel



Industry

LSV, Grinding wheels of abrasive fleece, tailor-made solution

Ordering example: LSV 100050 A 104 W Bore 13

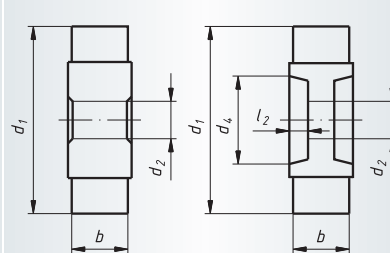

Packing unit:

Minimum ordering quantity 25 pcs. per type

v_{max} : 35 m/s

Other dimensions, bores or qualities, e.g. "very hard" or "Poly Urethane-foamed" are available on request. Possible diameters 80 mm to max. 400 mm.

A = reg. Aluminium Oxide

C = Silicon carbide

| Description | Grits | Quality | d ₁ mm | b mm | Bore d ₂ mm | recess on both sides d ₄ mm | recess on both sides l ₂ mm | n recom. (1/min) | n max. (1/min) | recommended for | |
|-------------|---------|---------|-------------------|------|------------------------|--|--|------------------|----------------|-----------------|---|
| LSV 100050 | A 104 W | soft | 100 | 50 | 13-16-20 | --- | --- | 3.000 | 6.000 | ① ② ③ ④ ⑤ ⑥ ⑦ ⑧ | ■ |
| LSV 100050 | A 106 W | soft | 100 | 50 | 13-16-20 | --- | --- | 3.000 | 6.000 | ① ② ③ ④ ⑤ ⑥ ⑦ ⑧ | ■ |
| LSV 100050 | A 107 W | soft | 100 | 50 | 13-16-20 | --- | --- | 3.000 | 6.000 | ① ② ③ ④ ⑤ ⑥ ⑦ ⑧ | ■ |
| LSV 100050 | C 204 W | soft | 100 | 50 | 13-16-20 | --- | --- | 3.000 | 6.000 | ① ② ③ ④ ⑤ ⑥ ⑦ ⑧ | ■ |
| LSV 100050 | C 206 W | soft | 100 | 50 | 13-16-20 | --- | --- | 3.000 | 6.000 | ① ② ③ ④ ⑤ ⑥ ⑦ ⑧ | ■ |
| LSV 100050 | C 207 W | soft | 100 | 50 | 13-16-20 | --- | --- | 3.000 | 6.000 | ① ② ③ ④ ⑤ ⑥ ⑦ ⑧ | ■ |



Industry

LSV, Grinding wheels of abrasive fleece, tailor-made solution

Ordering example: LSV 100050 A 104 M Bore 13

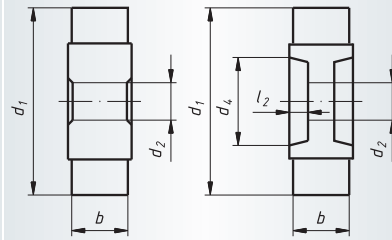

Packing unit:

Minimum ordering quantity 25 pcs. per type
 $v_{max.}$: 35 m/s

Other dimensions, bores or qualities, e.g. "very hard" or "Poly Urethane-foamed" are available on request. Possible diameters 80 mm to max. 400 mm.

A = reg. Aluminium Oxide
 C = Silicon carbide

| Description | Grits | Quality | d ₁ mm | b mm | Bore d ₂ mm | recess on both sides d ₄ mm | recess on both sides l ₂ mm | n recom. (1/min) | n max. (1/min) | recommended for | |
|-------------|---------|---------|-------------------|------|------------------------|--|--|------------------|----------------|-----------------|---|
| LSV 100050 | A 104 M | medium | 100 | 50 | 13-16-20 | --- | --- | 3.000 | 6.000 | 1 2 3 4 5 6 7 8 | ■ |
| LSV 100050 | A 106 M | medium | 100 | 50 | 13-16-20 | --- | --- | 3.000 | 6.000 | 1 2 3 4 5 6 7 8 | ■ |
| LSV 100050 | A 107 M | medium | 100 | 50 | 13-16-20 | --- | --- | 3.000 | 6.000 | 1 2 3 4 5 6 7 8 | ■ |
| LSV 100050 | C 204 M | medium | 100 | 50 | 13-16-20 | --- | --- | 3.000 | 6.000 | 1 2 3 4 5 6 7 8 | ■ |
| LSV 100050 | C 206 M | medium | 100 | 50 | 13-16-20 | --- | --- | 3.000 | 6.000 | 1 2 3 4 5 6 7 8 | ■ |
| LSV 100050 | C 207 M | medium | 100 | 50 | 13-16-20 | --- | --- | 3.000 | 6.000 | 1 2 3 4 5 6 7 8 | ■ |
| LSV 100050 | A 104 H | hard | 100 | 50 | 13-16-20 | --- | --- | 3.000 | 6.000 | 1 2 3 4 5 6 7 8 | ■ |
| LSV 100050 | A 106 H | hard | 100 | 50 | 13-16-20 | --- | --- | 3.000 | 6.000 | 1 2 3 4 5 6 7 8 | ■ |
| LSV 100050 | A 107 H | hard | 100 | 50 | 13-16-20 | --- | --- | 3.000 | 6.000 | 1 2 3 4 5 6 7 8 | ■ |
| LSV 100050 | C 204 H | hard | 100 | 50 | 13-16-20 | --- | --- | 3.000 | 6.000 | 1 2 3 4 5 6 7 8 | ■ |
| LSV 100050 | C 206 H | hard | 100 | 50 | 13-16-20 | --- | --- | 3.000 | 6.000 | 1 2 3 4 5 6 7 8 | ■ |
| LSV 100050 | C 207 H | hard | 100 | 50 | 13-16-20 | --- | --- | 3.000 | 6.000 | 1 2 3 4 5 6 7 8 | ■ |
| LSV 150050 | A 104 W | soft | 150 | 50 | 13-16-20 | 47 | 18 | 2.000 | 4.000 | 1 2 3 4 5 6 7 8 | ■ |
| LSV 150050 | A 106 W | soft | 150 | 50 | 13-16-20 | 47 | 18 | 2.000 | 4.000 | 1 2 3 4 5 6 7 8 | ■ |
| LSV 150050 | A 107 W | soft | 150 | 50 | 13-16-20 | 47 | 18 | 2.000 | 4.000 | 1 2 3 4 5 6 7 8 | ■ |
| LSV 150050 | C 204 W | soft | 150 | 50 | 13-16-20 | 47 | 18 | 2.000 | 4.000 | 1 2 3 4 5 6 7 8 | ■ |
| LSV 150050 | C 206 W | soft | 150 | 50 | 13-16-20 | 47 | 18 | 2.000 | 4.000 | 1 2 3 4 5 6 7 8 | ■ |
| LSV 150050 | C 207 W | soft | 150 | 50 | 13-16-20 | 47 | 18 | 2.000 | 4.000 | 1 2 3 4 5 6 7 8 | ■ |
| LSV 150050 | A 104 M | medium | 150 | 50 | 13-16-20 | 47 | 18 | 2.000 | 4.000 | 1 2 3 4 5 6 7 8 | ■ |
| LSV 150050 | A 106 M | medium | 150 | 50 | 13-16-20 | 47 | 18 | 2.000 | 4.000 | 1 2 3 4 5 6 7 8 | ■ |
| LSV 150050 | A 107 M | medium | 150 | 50 | 13-16-20 | 47 | 18 | 2.000 | 4.000 | 1 2 3 4 5 6 7 8 | ■ |
| LSV 150050 | C 204 M | medium | 150 | 50 | 13-16-20 | 47 | 18 | 2.000 | 4.000 | 1 2 3 4 5 6 7 8 | ■ |
| LSV 150050 | C 206 M | medium | 150 | 50 | 13-16-20 | 47 | 18 | 2.000 | 4.000 | 1 2 3 4 5 6 7 8 | ■ |
| LSV 150050 | C 207 M | medium | 150 | 50 | 13-16-20 | 47 | 18 | 2.000 | 4.000 | 1 2 3 4 5 6 7 8 | ■ |
| LSV 150050 | A 104 H | hard | 150 | 50 | 13-16-20 | 47 | 18 | 2.000 | 4.000 | 1 2 3 4 5 6 7 8 | ■ |
| LSV 150050 | A 106 H | hard | 150 | 50 | 13-16-20 | 47 | 18 | 2.000 | 4.000 | 1 2 3 4 5 6 7 8 | ■ |
| LSV 150050 | A 107 H | hard | 150 | 50 | 13-16-20 | 47 | 18 | 2.000 | 4.000 | 1 2 3 4 5 6 7 8 | ■ |
| LSV 150050 | C 204 H | hard | 150 | 50 | 13-16-20 | 47 | 18 | 2.000 | 4.000 | 1 2 3 4 5 6 7 8 | ■ |
| LSV 150050 | C 206 H | hard | 150 | 50 | 13-16-20 | 47 | 18 | 2.000 | 4.000 | 1 2 3 4 5 6 7 8 | ■ |
| LSV 150050 | C 207 H | hard | 150 | 50 | 13-16-20 | 47 | 18 | 2.000 | 4.000 | 1 2 3 4 5 6 7 8 | ■ |
| LSV 160050 | A 104 W | soft | 160 | 50 | 13-16-20 | 47 | 18 | 1.900 | 3.800 | 1 2 3 4 5 6 7 8 | ■ |
| LSV 160050 | A 106 W | soft | 160 | 50 | 13-16-20 | 47 | 18 | 1.900 | 3.800 | 1 2 3 4 5 6 7 8 | ■ |
| LSV 160050 | A 107 W | soft | 160 | 50 | 13-16-20 | 47 | 18 | 1.900 | 3.800 | 1 2 3 4 5 6 7 8 | ■ |
| LSV 160050 | C 204 W | soft | 160 | 50 | 13-16-20 | 47 | 18 | 1.900 | 3.800 | 1 2 3 4 5 6 7 8 | ■ |
| LSV 160050 | C 206 W | soft | 160 | 50 | 13-16-20 | 47 | 18 | 1.900 | 3.800 | 1 2 3 4 5 6 7 8 | ■ |
| LSV 160050 | C 207 W | soft | 160 | 50 | 13-16-20 | 47 | 18 | 1.900 | 3.800 | 1 2 3 4 5 6 7 8 | ■ |
| LSV 160050 | A 104 M | medium | 160 | 50 | 13-16-20 | 47 | 18 | 1.900 | 3.800 | 1 2 3 4 5 6 7 8 | ■ |
| LSV 160050 | A 106 M | medium | 160 | 50 | 13-16-20 | 47 | 18 | 1.900 | 3.800 | 1 2 3 4 5 6 7 8 | ■ |



LSV, Grinding wheels of abrasive fleece, tailor-made solution

Ordering example: LSV 160050 A 107 M Bore 13

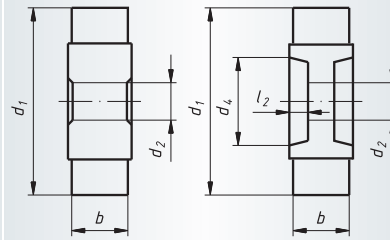

Packing unit:

Minimum ordering quantity 25 pcs. per type
 $v_{max.}$: 35 m/s

Other dimensions, bores or qualities, e.g. "very hard" or "Poly Urethane-foamed" are available on request. Possible diameters 80 mm to max. 400 mm.

A = reg. Aluminium Oxide
 C = Silicon carbide

| Description | Grits | Quality | d ₁ mm | b mm | Bore d ₂ mm | recess on both sides d ₄ mm | recess on both sides l ₂ mm | n recom. (1/min) | n max. (1/min) | recommended for | |
|-------------|---------|---------|-------------------|------|------------------------|--|--|------------------|----------------|-----------------|---|
| LSV 160050 | A 107 M | medium | 160 | 50 | 13-16-20 | 47 | 18 | 1.900 | 3.800 | 1 2 3 4 5 6 7 8 | ■ |
| LSV 160050 | C 204 M | medium | 160 | 50 | 13-16-20 | 47 | 18 | 1.900 | 3.800 | 1 2 3 4 5 6 7 8 | ■ |
| LSV 160050 | C 206 M | medium | 160 | 50 | 13-16-20 | 47 | 18 | 1.900 | 3.800 | 1 2 3 4 5 6 7 8 | ■ |
| LSV 160050 | C 207 M | medium | 160 | 50 | 13-16-20 | 47 | 18 | 1.900 | 3.800 | 1 2 3 4 5 6 7 8 | ■ |
| LSV 160050 | A 104 H | hard | 160 | 50 | 13-16-20 | 47 | 18 | 1.900 | 3.800 | 1 2 3 4 5 6 7 8 | ■ |
| LSV 160050 | A 106 H | hard | 160 | 50 | 13-16-20 | 47 | 18 | 1.900 | 3.800 | 1 2 3 4 5 6 7 8 | ■ |
| LSV 160050 | A 107 H | hard | 160 | 50 | 13-16-20 | 47 | 18 | 1.900 | 3.800 | 1 2 3 4 5 6 7 8 | ■ |
| LSV 160050 | C 204 H | hard | 160 | 50 | 13-16-20 | 47 | 18 | 1.900 | 3.800 | 1 2 3 4 5 6 7 8 | ■ |
| LSV 160050 | C 206 H | hard | 160 | 50 | 13-16-20 | 47 | 18 | 1.900 | 3.800 | 1 2 3 4 5 6 7 8 | ■ |
| LSV 160050 | C 207 H | hard | 160 | 50 | 13-16-20 | 47 | 18 | 1.900 | 3.800 | 1 2 3 4 5 6 7 8 | ■ |
| LSV 200025 | A 104 W | soft | 200 | 25 | 20-25-32 | 71 | 10 | 1.500 | 3.000 | 1 2 3 4 5 6 7 8 | ■ |
| LSV 200025 | A 106 W | soft | 200 | 25 | 20-25-32 | 71 | 10 | 1.500 | 3.000 | 1 2 3 4 5 6 7 8 | ■ |
| LSV 200025 | A 107 W | soft | 200 | 25 | 20-25-32 | 71 | 10 | 1.500 | 3.000 | 1 2 3 4 5 6 7 8 | ■ |
| LSV 200025 | C 204 W | soft | 200 | 25 | 20-25-32 | 71 | 10 | 1.500 | 3.000 | 1 2 3 4 5 6 7 8 | ■ |
| LSV 200025 | C 206 W | soft | 200 | 25 | 20-25-32 | 71 | 10 | 1.500 | 3.000 | 1 2 3 4 5 6 7 8 | ■ |
| LSV 200025 | C 207 W | soft | 200 | 25 | 20-25-32 | 71 | 10 | 1.500 | 3.000 | 1 2 3 4 5 6 7 8 | ■ |
| LSV 200025 | A 104 M | medium | 200 | 25 | 20-25-32 | 71 | 10 | 1.500 | 3.000 | 1 2 3 4 5 6 7 8 | ■ |
| LSV 200025 | A 106 M | medium | 200 | 25 | 20-25-32 | 71 | 10 | 1.500 | 3.000 | 1 2 3 4 5 6 7 8 | ■ |
| LSV 200025 | A 107 M | medium | 200 | 25 | 20-25-32 | 71 | 10 | 1.500 | 3.000 | 1 2 3 4 5 6 7 8 | ■ |
| LSV 200025 | C 204 M | medium | 200 | 25 | 20-25-32 | 71 | 10 | 1.500 | 3.000 | 1 2 3 4 5 6 7 8 | ■ |
| LSV 200025 | C 206 M | medium | 200 | 25 | 20-25-32 | 71 | 10 | 1.500 | 3.000 | 1 2 3 4 5 6 7 8 | ■ |
| LSV 200025 | C 207 M | medium | 200 | 25 | 20-25-32 | 71 | 10 | 1.500 | 3.000 | 1 2 3 4 5 6 7 8 | ■ |
| LSV 200025 | A 104 H | hard | 200 | 25 | 20-25-32 | 71 | 10 | 1.500 | 3.000 | 1 2 3 4 5 6 7 8 | ■ |
| LSV 200025 | A 106 H | hard | 200 | 25 | 20-25-32 | 71 | 10 | 1.500 | 3.000 | 1 2 3 4 5 6 7 8 | ■ |
| LSV 200025 | A 107 H | hard | 200 | 25 | 20-25-32 | 71 | 10 | 1.500 | 3.000 | 1 2 3 4 5 6 7 8 | ■ |
| LSV 200025 | C 204 H | hard | 200 | 25 | 20-25-32 | 71 | 10 | 1.500 | 3.000 | 1 2 3 4 5 6 7 8 | ■ |
| LSV 200025 | C 206 H | hard | 200 | 25 | 20-25-32 | 71 | 10 | 1.500 | 3.000 | 1 2 3 4 5 6 7 8 | ■ |
| LSV 200025 | C 207 H | hard | 200 | 25 | 20-25-32 | 71 | 10 | 1.500 | 3.000 | 1 2 3 4 5 6 7 8 | ■ |
| LSV 200050 | A 104 W | soft | 200 | 50 | 20-25-32 | 71 | 18 | 1.500 | 3.000 | 1 2 3 4 5 6 7 8 | ■ |
| LSV 200050 | A 106 W | soft | 200 | 50 | 20-25-32 | 71 | 18 | 1.500 | 3.000 | 1 2 3 4 5 6 7 8 | ■ |
| LSV 200050 | A 107 W | soft | 200 | 50 | 20-25-32 | 71 | 18 | 1.500 | 3.000 | 1 2 3 4 5 6 7 8 | ■ |
| LSV 200050 | C 204 W | soft | 200 | 50 | 20-25-32 | 71 | 18 | 1.500 | 3.000 | 1 2 3 4 5 6 7 8 | ■ |
| LSV 200050 | C 206 W | soft | 200 | 50 | 20-25-32 | 71 | 18 | 1.500 | 3.000 | 1 2 3 4 5 6 7 8 | ■ |
| LSV 200050 | C 207 W | soft | 200 | 50 | 20-25-32 | 71 | 18 | 1.500 | 3.000 | 1 2 3 4 5 6 7 8 | ■ |
| LSV 200050 | A 104 M | medium | 200 | 50 | 20-25-32 | 71 | 18 | 1.500 | 3.000 | 1 2 3 4 5 6 7 8 | ■ |
| LSV 200050 | A 106 M | medium | 200 | 50 | 20-25-32 | 71 | 18 | 1.500 | 3.000 | 1 2 3 4 5 6 7 8 | ■ |
| LSV 200050 | A 107 M | medium | 200 | 50 | 20-25-32 | 71 | 18 | 1.500 | 3.000 | 1 2 3 4 5 6 7 8 | ■ |
| LSV 200050 | C 204 M | medium | 200 | 50 | 20-25-32 | 71 | 18 | 1.500 | 3.000 | 1 2 3 4 5 6 7 8 | ■ |



Industry

LSV, Grinding wheels of abrasive fleece, tailor-made solution

Ordering example: LSV 200050 C 206 M Bore 20

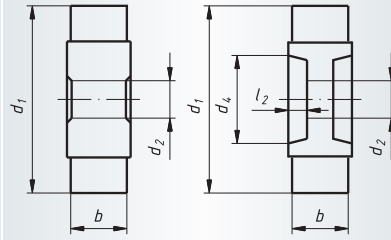

Packing unit:

Minimum ordering quantity 25 pcs. per type
 $v_{max.}$: 35 m/s

Other dimensions, bores or qualities, e.g. "very hard" or "Poly Urethane-foamed" are available on request. Possible diameters 80 mm to max. 400 mm.

A = reg. Aluminium Oxide
 C = Silicon carbide

| Description | Grits | Quality | d ₁ mm | b mm | Bore d ₂ mm | recess on both sides d ₄ mm | recess on both sides l ₂ mm | n recom. (1/min) | n max. (1/min) | recommended for | |
|-------------|---------|---------|-------------------|------|------------------------|--|--|------------------|----------------|-----------------|---|
| LSV 200050 | C 206 M | medium | 200 | 50 | 20-25-32 | 71 | 18 | 1.500 | 3.000 | 1 2 3 4 5 6 7 8 | ■ |
| LSV 200050 | C 207 M | medium | 200 | 50 | 20-25-32 | 71 | 18 | 1.500 | 3.000 | 1 2 3 4 5 6 7 8 | ■ |
| LSV 200050 | A 104 H | hard | 200 | 50 | 20-25-32 | 71 | 18 | 1.500 | 3.000 | 1 2 3 4 5 6 7 8 | ■ |
| LSV 200050 | A 106 H | hard | 200 | 50 | 20-25-32 | 71 | 18 | 1.500 | 3.000 | 1 2 3 4 5 6 7 8 | ■ |
| LSV 200050 | A 107 H | hard | 200 | 50 | 20-25-32 | 71 | 18 | 1.500 | 3.000 | 1 2 3 4 5 6 7 8 | ■ |
| LSV 200050 | C 204 H | hard | 200 | 50 | 20-25-32 | 71 | 18 | 1.500 | 3.000 | 1 2 3 4 5 6 7 8 | ■ |
| LSV 200050 | C 206 H | hard | 200 | 50 | 20-25-32 | 71 | 18 | 1.500 | 3.000 | 1 2 3 4 5 6 7 8 | ■ |
| LSV 200050 | C 207 H | hard | 200 | 50 | 20-25-32 | 71 | 18 | 1.500 | 3.000 | 1 2 3 4 5 6 7 8 | ■ |



Industry

LSM, Flap wheels of abrasive fleece with abrasive cloth, tailor-made solution

Ordering example: LSM 080050 A 104/80 Bore 13

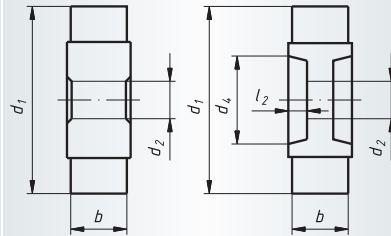

Packing unit:

Minimum ordering quantity 25 pcs. per type
 $v_{max.}$: 35 m/s

Other dimensions, bores or qualities are available on request. Possible diameters 80 mm to max. 400 mm.

A = reg. Aluminium Oxide
 C = Silicon carbide

| Description | Grits | d ₁ mm | b mm | Bore d ₂ mm | recess on both sides d ₄ mm | recess on both sides l ₂ mm | n recom. (1/min) | n max. (1/min) | recommended for | |
|-------------|-----------|-------------------|------|------------------------|--|--|------------------|----------------|-----------------|---|
| LSM 080050 | A 104/80 | 80 | 50 | 10-13-16 | --- | --- | 3.800 | 7.600 | 1 2 3 4 5 6 7 8 | ■ |
| LSM 080050 | A 106/150 | 80 | 50 | 10-13-16 | --- | --- | 3.800 | 7.600 | 1 2 3 4 5 6 7 8 | ■ |
| LSM 080050 | A 107/240 | 80 | 50 | 10-13-16 | --- | --- | 3.800 | 7.600 | 1 2 3 4 5 6 7 8 | ■ |
| LSM 080050 | C 204/80 | 80 | 50 | 10-13-16 | --- | --- | 3.800 | 7.600 | 1 2 3 4 5 6 7 8 | ■ |
| LSM 080050 | C 206/150 | 80 | 50 | 10-13-16 | --- | --- | 3.800 | 7.600 | 1 2 3 4 5 6 7 8 | ■ |
| LSM 080050 | C 207/240 | 80 | 50 | 10-13-16 | --- | --- | 3.800 | 7.600 | 1 2 3 4 5 6 7 8 | ■ |
| LSM 150050 | A 104/80 | 150 | 50 | 13-16-20 | 47 | 18 | 2.000 | 4.000 | 1 2 3 4 5 6 7 8 | ■ |
| LSM 150050 | A 106/150 | 150 | 50 | 13-16-20 | 47 | 18 | 2.000 | 4.000 | 1 2 3 4 5 6 7 8 | ■ |
| LSM 150050 | A 107/240 | 150 | 50 | 13-16-20 | 47 | 18 | 2.000 | 4.000 | 1 2 3 4 5 6 7 8 | ■ |
| LSM 150050 | C 204/80 | 150 | 50 | 13-16-20 | 47 | 18 | 2.000 | 4.000 | 1 2 3 4 5 6 7 8 | ■ |
| LSM 150050 | C 206/150 | 150 | 50 | 13-16-20 | 47 | 18 | 2.000 | 4.000 | 1 2 3 4 5 6 7 8 | ■ |
| LSM 150050 | C 207/240 | 150 | 50 | 13-16-20 | 47 | 18 | 2.000 | 4.000 | 1 2 3 4 5 6 7 8 | ■ |
| LSM 160050 | A 104/80 | 160 | 50 | 13-16-20 | 47 | 18 | 1.900 | 3.800 | 1 2 3 4 5 6 7 8 | ■ |
| LSM 160050 | A 106/150 | 160 | 50 | 13-16-20 | 47 | 18 | 1.900 | 3.800 | 1 2 3 4 5 6 7 8 | ■ |



LSM, Flap wheels of abrasive fleece with abrasive cloth, tailor-made solution

Ordering example: LSM 160050 A 107/240 Bore 16

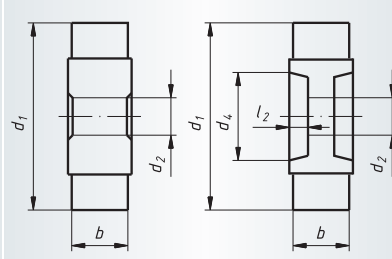

Packing unit:

Minimum ordering quantity 25 pcs. per type

v_{max} : 35 m/s

Other dimensions, bores or qualities are available on request. Possible diameters 80 mm to max. 400 mm.

A = reg. Aluminium Oxide
C = Silicon carbide

| Description | Grits | d ₁ mm | b mm | Bore d ₂ mm | recess on both sides d ₄ mm | recess on both sides l ₂ mm | n recom. (1/min) | n max. (1/min) | recommended for | |
|-------------|-----------|-------------------|------|------------------------|--|--|------------------|----------------|-----------------|---|
| LSM 160050 | A 107/240 | 160 | 50 | 13-16-20 | 47 | 18 | 1.900 | 3.800 | 1 2 3 4 5 6 7 8 | ■ |
| LSM 160050 | C 204/80 | 160 | 50 | 13-16-20 | 47 | 18 | 1.900 | 3.800 | 1 2 3 4 5 6 7 8 | ■ |
| LSM 160050 | C 206/150 | 160 | 50 | 13-16-20 | 47 | 18 | 1.900 | 3.800 | 1 2 3 4 5 6 7 8 | ■ |
| LSM 160050 | C 207/240 | 160 | 50 | 13-16-20 | 47 | 18 | 1.900 | 3.800 | 1 2 3 4 5 6 7 8 | ■ |
| LSM 200050 | A 104/80 | 200 | 50 | 20-25-32 | 71 | 18 | 1.500 | 3.000 | 1 2 3 4 5 6 7 8 | ■ |
| LSM 200050 | A 106/150 | 200 | 50 | 20-25-32 | 71 | 18 | 1.500 | 3.000 | 1 2 3 4 5 6 7 8 | ■ |
| LSM 200050 | A 107/240 | 200 | 50 | 20-25-32 | 71 | 18 | 1.500 | 3.000 | 1 2 3 4 5 6 7 8 | ■ |
| LSM 200050 | C 204/80 | 200 | 50 | 20-25-32 | 71 | 18 | 1.500 | 3.000 | 1 2 3 4 5 6 7 8 | ■ |
| LSM 200050 | C 206/150 | 200 | 50 | 20-25-32 | 71 | 18 | 1.500 | 3.000 | 1 2 3 4 5 6 7 8 | ■ |
| LSM 200050 | C 207/240 | 200 | 50 | 20-25-32 | 71 | 18 | 1.500 | 3.000 | 1 2 3 4 5 6 7 8 | ■ |





Always the right tool

Tungsten-carbide burrs: Our customers appreciate the precise running smoothness and perfectly finished gears which ensure the utmost chip removal.

Jayesh Shah
Sales Department

www.lukas-erzett.com



FRV, Mops of abrasive fleece

Ordering example: FRV 20005 A 104 Bore 20

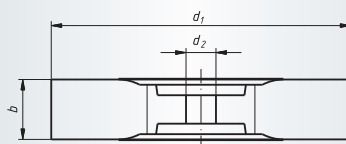

Packing unit:

Minimum ordering quantity 25 pcs. per type
A = reg. Aluminium Oxide

| Description | Grits | Quality | d ₁ mm | b mm | d ₂ mm | n recom. (1/min) | n max. (1/min) | recommended for | |
|-------------|-------|-----------|-------------------|------|-------------------|------------------|----------------|-----------------|---|
| FRV 20050 | A 104 | medium | 200 | 50 | 20-25-32 | 1.400 | 1.900 | 1 2 3 4 5 6 7 8 | ■ |
| FRV 20050 | A 106 | fine | 200 | 50 | 20-25-32 | 1.400 | 1.900 | 1 2 3 4 5 6 7 8 | ■ |
| FRV 20050 | A 107 | very fine | 200 | 50 | 20-25-32 | 1.400 | 1.900 | 1 2 3 4 5 6 7 8 | ■ |
| FRV 25050 | A 104 | medium | 250 | 50 | 20-25-32 | 1.100 | 1.500 | 1 2 3 4 5 6 7 8 | ■ |
| FRV 25050 | A 106 | fine | 250 | 50 | 20-25-32 | 1.100 | 1.500 | 1 2 3 4 5 6 7 8 | ■ |
| FRV 25050 | A 107 | very fine | 250 | 50 | 20-25-32 | 1.100 | 1.500 | 1 2 3 4 5 6 7 8 | ■ |
| FRV 30060 | A 104 | medium | 300 | 60 | 20-25-32 | 900 | 1.200 | 1 2 3 4 5 6 7 8 | ■ |
| FRV 30060 | A 106 | fine | 300 | 60 | 20-25-32 | 900 | 1.200 | 1 2 3 4 5 6 7 8 | ■ |
| FRV 30060 | A 107 | very fine | 300 | 60 | 20-25-32 | 900 | 1.200 | 1 2 3 4 5 6 7 8 | ■ |

LUKAS Fleece Mops are manufactured from abrasive fleece and are used when a satin polish is required on stainless, chrome, nickel and non ferrous metals. They are also ideal for cleaning-up and enhancing painted and varnished surfaces in the wood and plastic industries. Furthermore, they are suited to the manufacture of stainless and aluminium containers supplied to the food industry.

The ideal operating speed lies between 10 – 20 m/s and the fleece mops should

be used with little pressure. They can be used with or without coolant. Operating with coolant extends the life of the fleece mop.

When using water as a coolant a matt surface is achieved; oil produces a satin finish. LUKAS Fleece Mops can be clamped together on a single spindle thus giving the overall width required.



LSW, Rolls manufactured of abrasive fleece

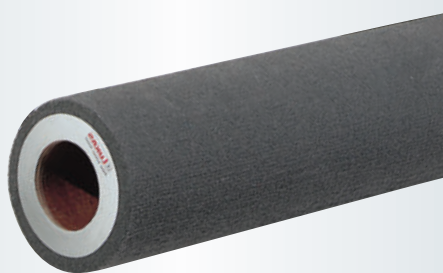

Rolls with a diameter of 100 to 400 mm and a width of 100 to 1.000 mm are available with various bores and qualities of abrasive fleece.

available on request

Always the right tool

Cutting discs: Our customers keep asking for thin cuts, quick, cool, precise and free from burrs: Therefore the ROTTLUFF products fit perfectly into our product range.

Georg Klug
Marketing

